

CHICAGO WATER TOWER

The crown jewel of the Chicago skyline

415
ROOMS

33
SUITES

10
MEETING ROOMS

15 TO 400
EVENT CAPACITY



Sofitel creates unique, contemporary luxury hotels and resorts in the world's most attractive destinations by artfully blending its French origins with local cultures and styles. Our guests seek incomparable comfort, unsurpassed service and extraordinary cuisine. To exceed their expectations, we balance each element and detail with consummate savoir-faire. With French tradition and modern flair, we care for each individual guest at each individual moment. The result:

a Sofitel experience that enchants, intrigues and refreshes.

The ultimate Chicago destination

Stunning views of Lake Michigan and the Chicago skyline surround the soaring glass and dramatic angles of this urban wonder by noted French architect Jean-Paul Viguier. From the breathtaking lobby and beautifully appointed meeting spaces to elegant rooms and suites, you'll discover the perfect blend of modern style and Sofitel luxury.

Location

At home in the heart of downtown Chicago's prestigious Gold Coast district, the Sofitel Chicago Water Tower is just steps from the world-renowned shopping of the Magnificent Mile, the nightlife of Rush Street, the River North Gallery District, the Museum of Contemporary Art and Lake Michigan.

Accommodations

Sofitel Chicago Water Tower welcomes you with 415 rooms on 32 floors, including 32 suites and one presidential suite. Room amenities include SoBed™—Sofitel's luxurious feathertop and duvet sleep system, LCD flat-panel TV with laptop connections, wired and wireless Internet access, Bose® Wave® music system, minibar, safe deposit box, and a spacious bath with separate tub and shower and luxurious French toiletries.

Services

Events come naturally with more than 10,000 square feet of meeting and banquet space, including Cigale, a private dining room with open kitchen; complimentary Internet stations; valet parking; and taxi and limousine service.

Pets are welcome.

Restaurants & Bars

Café des Architectes. Savor seasonal French cuisine in a stylish and contemporary setting with a dining room and outdoor terrace.

Le Bar. Enjoy specialty martinis and an extensive Champagne and wine list in this chic bar with dramatic floor-to-ceiling windows.

Recreation

Fitness center
Massage

Attractions

Art Institute of Chicago
Field Museum
Hancock Observatory
Lincoln Park Zoo
Magnificent Mile
Millennium Park
Museum of Science and Industry
Navy Pier
Shedd Aquarium
Water Tower Place
Wrigley Field

Access

O'Hare Airport (ORD)
Midway Airport (MDW)

SOFITEL CHICAGO WATER TOWER

20 EAST CHESTNUT STREET
CHICAGO, IL 60611 USA
PHONE: 312-324-4000
SALES: 312-324-4012
FAX: 312-324-4026

EMAIL: SOFITEL.CHICAGOWATERTOWER@SOFITEL.COM
WWW.SOFITEL.COM
800-SOFITEL

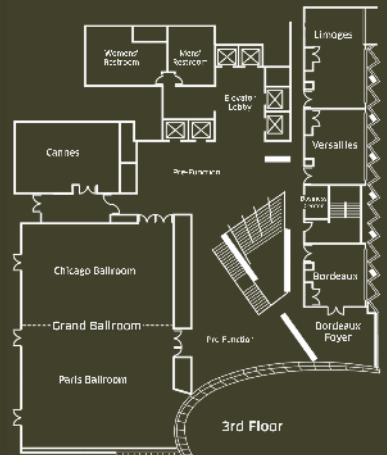
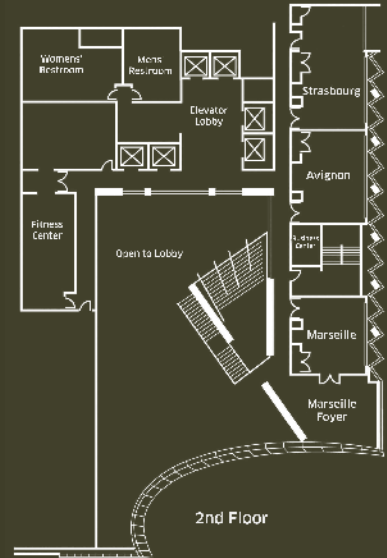
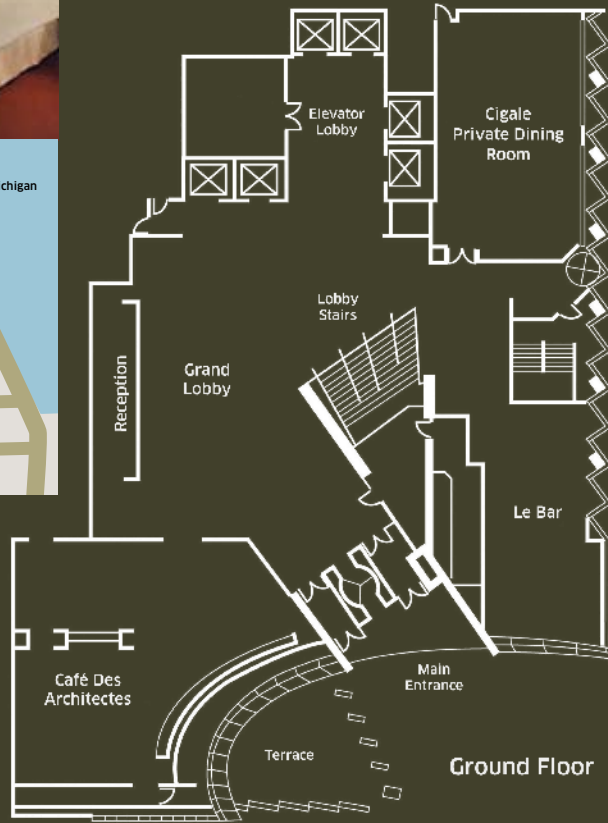

ROOM	AREA (FT)	LENGTH (FT)	WIDTH (FT)	CLASSROOM	THEATER	U-SHAPE	BOARD	BANQUET	RECEPTION
STRASBOURG	681	36.6	18.6	40/35	65	28/22	20/18	60	50
AVIGNON	518	19	27.25	32/24	45	20/16	15/12	50	40
MARSEILLE/FOYER	418	19	22	24/18	35	16/14	15/12	40	60
LIMOGES	681	36.6	18.6	40/35	65	28/22	20/18	60	50
VERSAILLES	518	19	27.25	32/24	45	20/16	15/12	50	40
BORDEAUX/FOYER	418	19	22	24/18	35	16/14	15/12	40	60
CANNES	870	23	37.8	50/40	85	30/25	26/20	60	60
CHICAGO	2072	37	56	110	200	45	n/a	150	200
PARIS	2520	45	56	140	225	55	n/a	160	225
GRAND BALLROOM	4592	82	56	260	400	120	n/a	300	400
PREFUNCTION	2820	n/a	n/a	n/a	n/a	n/a	n/a	n/a	250
PRIVATE DINING ROOM	1092	26	42	n/a	n/a	n/a	n/a	55	75

