



**I** INTERCONTINENTAL.  
TAMPA

Above everything else, Tampa is a city that represents the best of Florida's historic past and limitless future. Spectacular beaches stretch for endless miles and the mild climate speaks to guests and residents alike. A thriving business district pulsates with the very beat of a much larger city. The InterContinental Tampa is just minutes from the Tampa International Airport and easily accessible to downtown and the convention center. Exit 40A, Westshore Boulevard from I-275.

**OFF-SITE RECREATION**

The staff at The InterContinental Tampa will always be at your service and will happily arrange outings to any of Tampa's local attractions.

- Westshore Plaza Mall
- International Plaza Mall
- Raymond James Stadium, home of the Tampa Bay Buccaneers
- Legends Field, spring training site of the New York Yankees
- St. Pete Times Forum, home of the Tampa Bay Lightning
- Busch Gardens
- Adventure Island
- The Florida Aquarium
- Lowry Park Zoo
- Championship golf and the beautiful beaches of St. Petersburg/Clearwater – just 20 minutes from the hotel
- Walt Disney World, Universal Studios, Epcot, Sea World and many more attractions – all within an hour's drive

**THE ESSENTIALS**

**PREMIERING**

The InterContinental Tampa will be the newest luxury hotel in the city's bustling, upscale Westshore business and shopping district. Featuring a contemporary, comfortable feel, the hotel's design will be reflective of the Florida seaside and the casual elegance of a fine business hotel. The hotel will offer truly distinctive, warm hospitality in the InterContinental style and will feature 323 richly appointed guest rooms and suites, as well as more than 21,000 square feet of meeting and event spaces.

The hotel will reopen in Fall 2007 as the new InterContinental Tampa.



*Tampa Bay offers a unique blend of urban excitement in a natural surrounding.*

**DESTINATION**

# RENOVATION



Lowe Enterprises has committed more than \$18 million to completely remodel and reposition the hotel as a luxury InterContinental hotel, managed by Destination Hotels and Resorts.

- The entire hotel will be renovated in a sophisticated style, yet casual feel.
- Once completed, the hotel will offer more than 21,000 square feet of event space, including 7,000 square feet of atrium function space.
- Six of the hotel's junior suites will be upgraded to business suites with ergonomic chairs, meeting tables and outfitted for technology.
- The lobby will get a bright new look, creating a fresh, casual yet elegant atmosphere.

## DESIGN

The design of the new InterContinental Tampa is a playful mix of contrasts – homage to the historical, coastal setting of Tampa set against a corporate urban location.

# GUEST AMENITIES

- Guest rooms are 284 square feet
- King bed or two double beds with deluxe linens, pillow top mattresses and luxurious pillows
- Flat panel LCD television
- Alarm clock with iPod docking station
- Custom bathroom amenities
- Salon style hair dryer
- Wireless and wired high-speed Internet access.
- Iron and ironing board
- In-room safe large enough to accommodate a laptop
- Fully stocked mini refreshment bar
- Dual line speaker phones
- Twice daily housekeeping services

## GUEST ROOMS and SUITES

The 323 elegantly appointed guest rooms will offer a completely new décor with stone and marble bathrooms, luxury linens and flat panel LCD televisions.

- Two presidential suites
- Four corner parlor suites
- 17 junior suites – six of which will be designed for the business traveler



# DINING

The hotel will offer a variety of food and beverage experiences.

- Shula's Steak House serves breakfast, lunch and dinner daily. Created by legendary Miami Dolphins' coach Don Shula, the restaurant features Certified Angus Beef and exceptional service.
- The lobby will feature a lounge in which to relax between meetings or for drinks before dinner at Shula's.
- A coffee bar will offer all-day service.
- Both the lounge and coffee bar will be surrounded by a living room style setting with built-in business functionality to make this space ideal for business or leisure.
- 24 hour room service.

## HEALTH and FITNESS

Continue your workouts while you're staying at the InterContinental Tampa. The hotel will feature a state-of-the-art workout center for both strength and cardio workouts.

# MEETINGS AND EVENTS

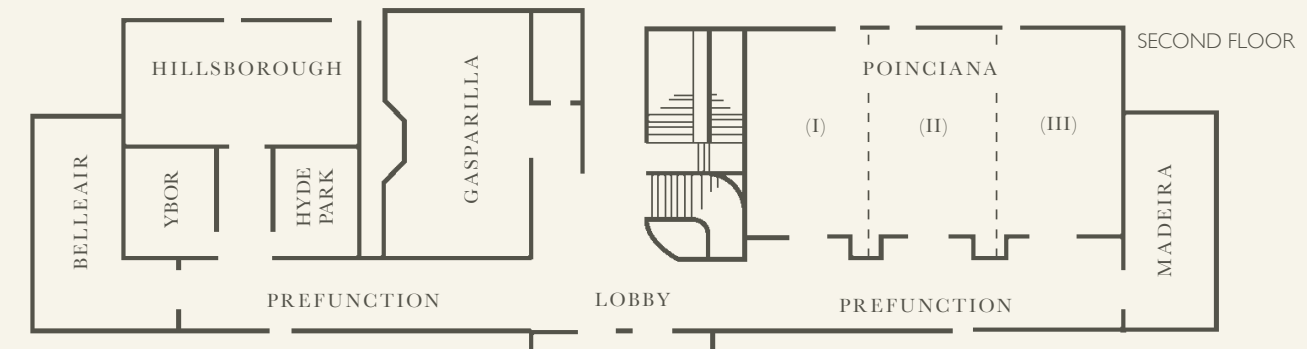
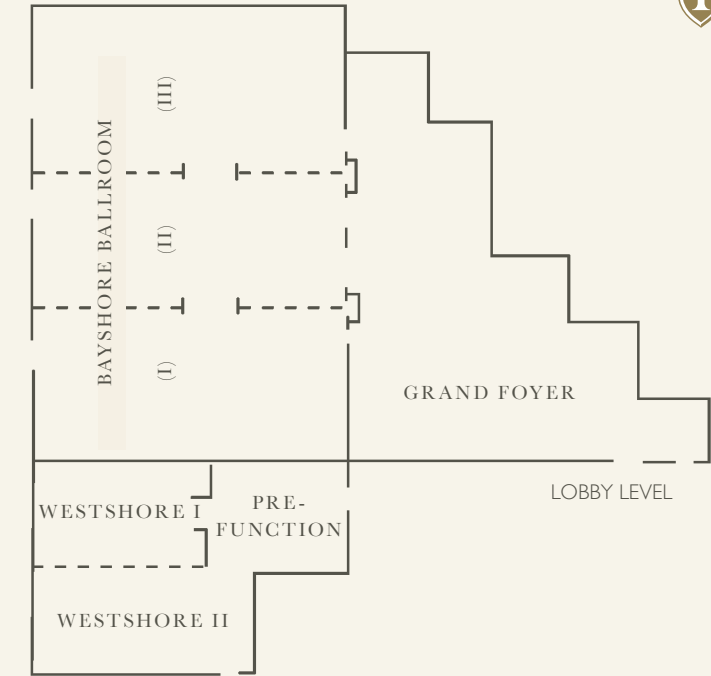

	Dimensions	Sq. Ft.	Ceiling Height	Reception	Banquet	Theater	Classroom	Conference	U-Shape
Bayshore Ballroom	87' x 58'	5,046	16'	700	450	700	360	135	125
I, II, III	29' x 58'	1,682	16'	200	120	210	125	45	40
Grand Foyer	•	3,113	•	500	•	•	•	•	•
Poinciana	51' x 29'	1,479	9'6"	175	100	140	100	55	45
I	16' x 29'	464	9'6"	50	20	30	20	20	15
II	17' x 29'	493	9'6"	60	30	40	30	25	20
III	18' x 29'	522	9'6"	60	30	40	30	25	20
Prefunction	50' x 8'	400	•	•	•	•	•	•	•
Ybor	12' x 16'	192	10'	15	10	10	10	10	•
Hillsborough	16' x 32'	512	10'	60	30	65	30	30	25
Hyde Park	12' x 16'	192	8'	15	10	10	10	10	•
Prefunction	50' x 8'	400	•	•	•	•	•	•	•
	16' x 8'	128	•	•	•	•	•	•	•
Madeira	13' x 28'	364	10'	25	24	25	15	18	15
Belleair	13' x 28'	364	10'	•	10	•	•	12	•
Gasparilla	34' x 23'	782	Varies	•	•	•	40	•	•
Garden Atrium	•	3,500	•	400	225	•	•	•	•
Westshore I	23' x 33'	759	9'	60	50	60	40	30	20
Westshore II	46' x 20'	920	9'	70	60	100	50	35	30
Westshore Prefunction	23' x 33'	759	•	•	•	•	•	•	•

\*Our meeting room capacities have been calculated using the Meeting Professionals International Comfort Calendar.