

BALLROOM LEVEL

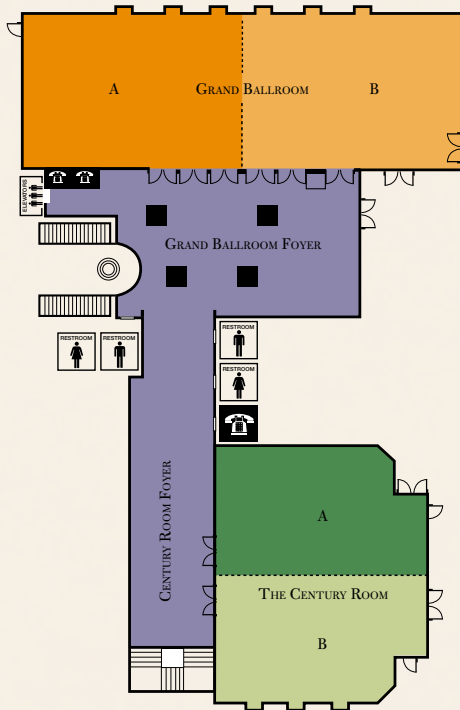

The Adolphus, built in 1912 by beer baron Adolphus Busch and splendidly restored to accommodate a new generation of discerning travelers, is an architectural gem, considered by many to be “the most beautiful building west of Venice.”

An idyllic blend of classic elegance and modern-day conveniences, this Dallas grande dame offers more than 24,000 square feet of tastefully designed meeting space, complemented by essential business amenities such as high-speed Internet access and state-of-the-art multimedia services.

Steeped in tradition, alive with Texas Southern charm and within walking distance of Dallas’s arts and financial districts and the Dallas Convention Center, The Adolphus has been a meeting planner’s dream since its gilded doors first opened nearly a century ago.

REGISTRATION LEVEL

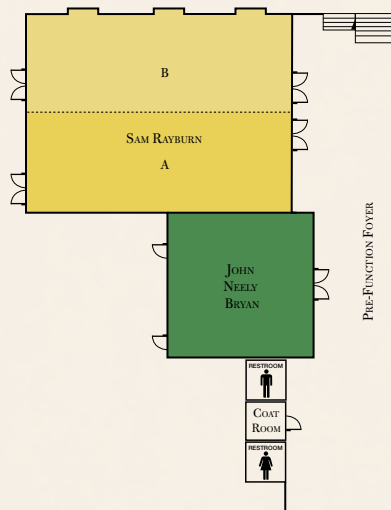

MEZZANINE LEVEL



# MEETING FACILITY OVERVIEW

## BALLROOM LEVEL

ROOM NAME	SQ. FT.	DIMENSIONS	THEATER	CLASSROOM		U-SHAPE	CONFERENCE	RECEPTION	BANQUET	CEILING HEIGHTS
				18'-2/6"	18'-3/6"					
GRAND BALLROOM	5304	38'3" x 138'8"	800	250	375	150	132	800	540	20'6"
BALLROOM A	2652	38'3" x 69'4"	400	120	180	70	60	400	270	20'6"
BALLROOM B	2652	38'3" x 69'4"	400	120	180	70	60	400	270	20'6"
GRAND BALLROOM FOYER	2436	58' x 42'	N/A	N/A	N/A	N/A	N/A	N/A	N/A	8'4"
THE CENTURY ROOM	4440	74' x 60'	650	180	280	80	78	600	420	17'
CENTURY ROOM A	2220	37' x 60'	325	100	150	55	54	300	210	17'
CENTURY ROOM B	2220	37' x 60'	325	100	150	55	54	300	210	17'
CENTURY ROOM FOYER	1632	16' x 102'	N/A	N/A	N/A	N/A	N/A	N/A	N/A	10'10"

## MEZZANINE LEVEL

ROOM NAME	SQ. FT.	DIMENSIONS	THEATER	CLASSROOM		U-SHAPE	CONFERENCE	RECEPTION	BANQUET	CEILING HEIGHTS
				18'-2/6"	18'-3/6"					
DAVID G. BURNET	989	23' x 43'	110	30	50	35	40	90	80	8'4"
ANSON JONES	1305	59'9" x 19'8"	150	46	70	45	54	150	120	7'11"
SECTION A	380	19'2" x 19'8"	24	10	16	12	18	30	30	7'11"
SECTION B	435	22' x 19'8"	60	20	30	24	24	40	50	7'11"
SECTION C	490	18'7" x 26'5"	60	20	30	15	24	40	40	7'11"
DAN MOODY	1222	23'6" x 52'	110	40	60	35	40	100	80	8'
PAT MORRIS NEFF	1044	43'6" x 24'	110	40	60	35	40	100	80	8'10"
DIRECTORS	282	23'7" x 12'	N/A	N/A	N/A	N/A	14	N/A	N/A	8'10"
EXECUTIVE	322	23'2" x 13'10"	N/A	N/A	N/A	N/A	14	N/A	N/A	8'10"
BOARD	263	19'5" x 13'6"	N/A	N/A	N/A	N/A	8	N/A	N/A	8'10"
PRESIDENTS	294	24'1" x 12'3"	N/A	N/A	N/A	N/A	12	N/A	N/A	8'10"
SAM HOUSTON	1315	54'10" x 24'	100	46	70	45	54	150	100	8'10"
SECTION A	408	17' x 24'	30	12	20	12	18	20	30	8'10"
SECTION B	504	21' x 24'	30	12	20	12	18	40	40	8'10"
SECTION C	403	16'10" x 24'	30	12	20	12	18	40	30	8'10"
JAMES ALLRED	289	17' x 17'2"	25	10	15	12	14	30	20	8'10"
W. LEE O'DANIEL	361	18'11" x 19'	N/A	N/A	N/A	N/A	10	N/A	N/A	9'4"

## REGISTRATION LEVEL

ROOM NAME	SQ. FT.	DIMENSIONS	THEATER	CLASSROOM		U-SHAPE	CONFERENCE	RECEPTION	BANQUET	CEILING HEIGHTS
				18'-2/6"	18'-3/6"					
SAM RAYBURN	2200	44' x 50'	280	100	150	60	54	250	200	10'
SECTION A	1100	22' x 50'	140	46	70	36	36	120	100	10'
SECTION B	1100	22' x 50'	140	46	70	36	36	120	100	10'
JOHN NEELY BRYAN	826	29' x 28'6"	90	26	40	28	24	50	50	10'