

# Biltmore

CORAL GABLES + MIAMI



## Address

1200 Anastasia Ave.  
 Coral Gables, FL 33134 . . . . . 305/445-1926  
 Biltmore reservations: . . . . . 800/727-1926  
 Sales Fax: . . . . . 305/913-3152  
 Guest Fax: . . . . . 305/913-3159  
 www.biltmorehotel.com

## Location

Biltmore is located in the heart of Coral Gables, minutes from Miami International Airport, the Port of Miami, Downtown Miami, Coconut Grove and Miami Beach's historic Art Deco District.

## Guest Room Information

Number of rooms: . . . . . 273  
 Number of suites: . . . . . 130  
 Number of floors: . . . . . 15  
 Check-in time: . . . . . 3 p.m.  
 Check-out time: . . . . . Noon

A classic luxury resort opened in 1926, extensively renovated over the past decade.

## Conference Rooms and Meeting Facilities

The Biltmore offers more than 76,000 square feet of indoor/outdoor meeting and function space, set amidst the hotel's

### Distinctively Ours...

The Biltmore is a national historic monument nestled in the heart of Coral Gables. Elegant surroundings and superb meeting facilities. The Biltmore is a member of the Leading Hotels of the World.

historic ambiance. The facilities are housed within two locations on the Biltmore grounds – within the hotel itself and at the adjacent Conference Center of the Americas (CCA).

The Conference Center of the Americas offers exceptional function space including two state-of-the-art amphitheatres, breakout rooms, a grand ballroom, executive boardrooms and the hotel's business center.

The hotel features elegant twin ballrooms with scenic outdoor terraces. Meeting rooms of various sizes are conveniently located along one wing on the lobby level. All operational systems and services are integrated between the Biltmore and the CCA so that attendees enjoy meeting and hotel experiences of outstanding quality.

All meeting rooms are supported by powerful technology including wired and wireless high-speed Internet and videoconferencing capability. Three elegant classrooms offer built-in LCD rear-screen projection and advanced sound.

The two, tiered amphitheatres, seating 60-90 and 90-120 persons, provide dedicated wireless simultaneous translation and audience response systems. Every participant station is wired for 120 v., Ethernet, analog phone lines and personal task lighting. Both amphitheatres have full audio and video support and complete remote control of the room from each speaker's podium.

## Special Events Served With Elegance

The Biltmore offers exceptional facilities and amenities for meetings and distinguished events, with luxurious and highly flexible accommodations, state-of-the-art conference technology, top-notch catering and highly personalized service.

### Unique Biltmore Details

- 273 luxurious guest rooms, including 36 specialty suites
- 76,000 square feet of indoor/outdoor meeting and function space
- 3 grand ballrooms, 2 state-of-the-art amphitheatres, executive boardroom and a total of 26 function rooms
- Within minutes of South Beach, Coconut Grove, Downtown Miami and local area attractions.
- Valet and complimentary self-parking
- Destination management, audiovisual and transportation companies all offered on property
- Complimentary high speed internet in all areas

### Amenities

- Diverse selection of dining experiences including the 2010 Top Restaurant Zagat Rated Palme d'Or
- Donald Ross designed 18-hole championship golf course
- 12,000 square foot full service spa with 12 treatment rooms and private spa suite
- Ranked one of the "Top 10 Hotel Fitness Centers" in the US by Men's Fitness
- Recreational Culinary Academy offering team-building and private classes
- Largest hotel pool in the continental US surrounded by 9 private poolside cabana suites
- Ten lighted tennis courts for night play
- An array of activities including shopping, high tea and nightly entertainment
- Total Performance Golf – A Titleist program designed to improve your golf swing

## General Information

**Credit Cards Accepted:** American Express, Diners Club, Discover, MasterCard, Visa.

**Reservations:** Cancellation must be made 48 hours prior to arrival or one night's stay will be charged to the individual.

## The Biltmore

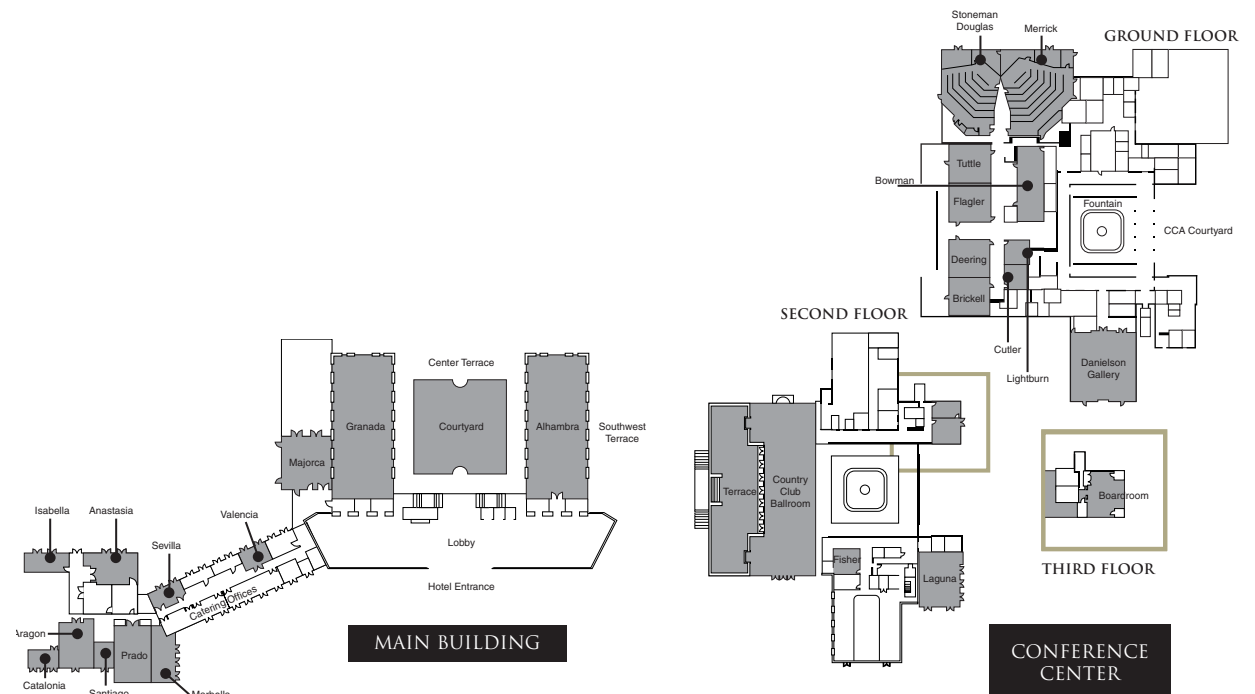

ROOM	SQUARE FEET	SQUARE METERS	CONFERENCE	RECEPTION	THEATRE	CLASSROOM	U-SHAPE	HOLLOW SQ.	ROUNDS
<b>Main Building</b>									
Alhambra	3744	1141	86	500	450	224	90	100	320
Granada	3744	1141	86	500	450	224	90	100	320
Majorca	852	259	28	70	70	50	32	40	70
Marbella	701	213	28	60	65	44	30	36	60
Prado	1373	418	40	100	140	88	48	58	120
Anastasia	734	223	28	60	70	48	30	40	60
Santiago	262	79	12	-	18	8	-	-	12
Aragon	1134	345	34	90	120	72	38	44	96
Isabella	356	108	12	-	-	-	-	-	-
Catalonia	365	111	10	-	-	-	-	-	-
Valencia	334	101	18	-	-	-	-	-	-
Sevilla	400	122	10	-	-	-	-	-	-
<b>Conference Center</b>									
Stoneman Douglas	2496	760	-	-	-	60	-	-	-
Merrick	3520	1072	-	-	-	90	-	-	-
Tuttle	929	283	24	80	72	40	30	38	60
Flagler	871	265	24	40	60	42	25	30	50
Bowman	1271	387	50	120	135	72	54	60	110
Deering	871	265	24	40	60	42	25	30	50
Lightburn	385	117	16	-	32	20	16	20	20
Brickell	934	284	24	80	72	40	30	38	60
Cutler	385	117	16	-	32	20	16	20	20
Danielson Gallery	2933/1900	894/579	44/44	350	120	72/60	50	58	180/120
Boardroom	686	209	18	-	-	-	-	-	-
CC Ballroom	6528	1989	124	700	600	325	130	140	540
Laguna	1472	449	40	100	68	32	-	-	110
Fisher	378	115	18	-	24	12	-	-	20