

# Keystone Lodge & Spa meeting rooms (2nd Floor)

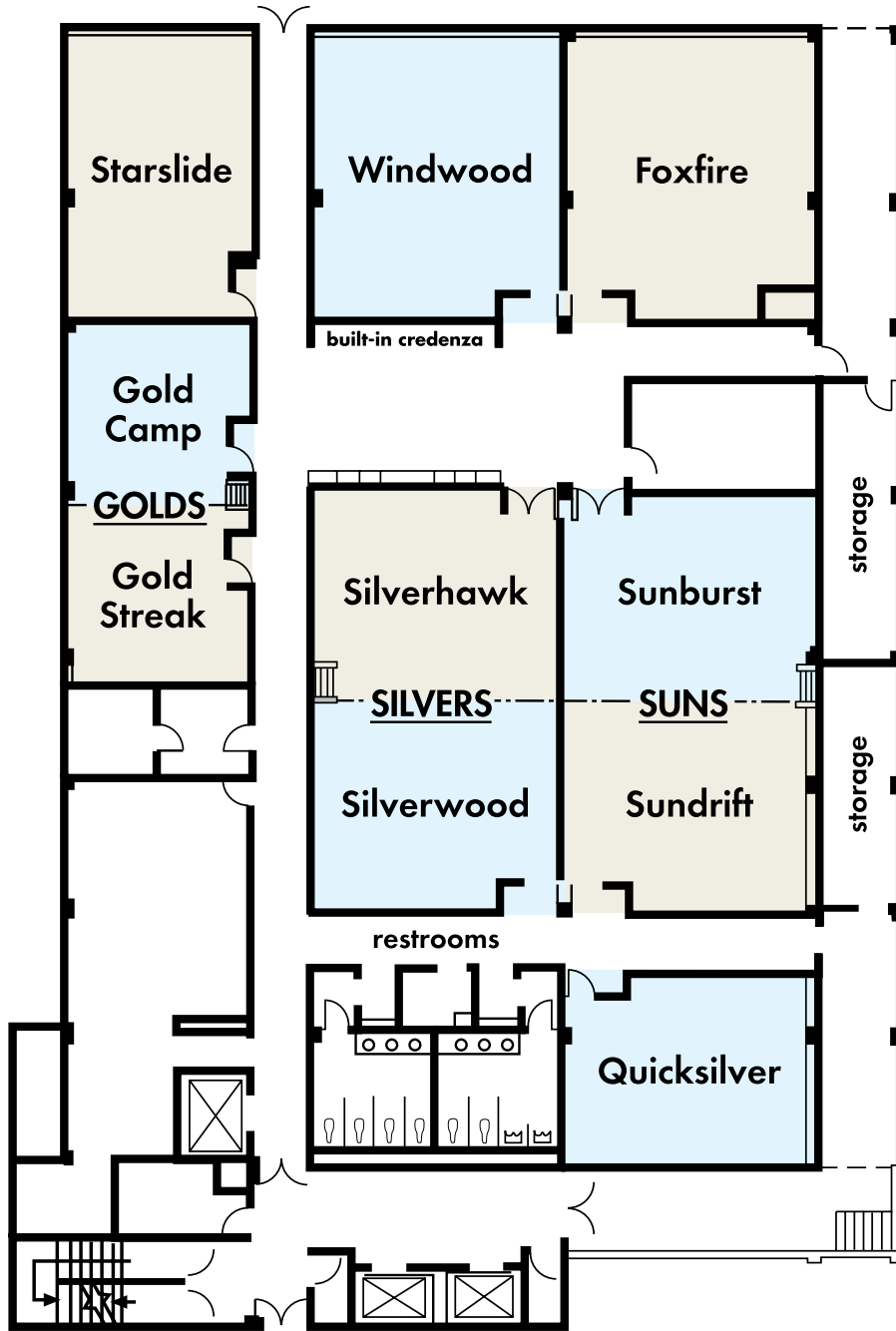

	Square Footage	Dimensions LxWxH	Theater	Schoolroom	Conference	Hollow Square	U-Shape	Reception	Dining Rounds of 12 people
<b>GOLDS</b>	<b>580</b>	<b>34X17X8'6</b>	<b>30</b>	<b>16</b>	<b>16</b>	<b>16</b>	<b>12</b>	<b>40</b>	<b>36</b>
<b>GOLDCAMP</b>	290	17X17X8'6	12	8	8	8	6	20	12
<b>GOLDSTREAK</b>	290	17X17X8'6	12	48	8	8	6	20	12
<b>SILVERS</b>	<b>920</b>	<b>40X23X8'6</b>	<b>90</b>	<b>48</b>	<b>30</b>	<b>40</b>	<b>32</b>	<b>95</b>	<b>60</b>
<b>SILVERHAWK</b>	460	20X23X8'6	40	24	16	16	12	45	24
<b>SILVERWOOD</b>	460	20X23X8'6	40	24	16	16	12	45	24
<b>SUNS</b>	<b>920</b>	<b>40X23X8'6</b>	<b>90</b>	<b>48</b>	<b>30</b>	<b>40</b>	<b>32</b>	<b>95</b>	<b>60</b>
<b>SUNBURST</b>	460	20X23X8'6	40	24	16	16	12	45	24
<b>SUNDRIFT</b>	460	20X23X8'6	40	24	16	16	12	45	24
<b>QUICKSILVER</b>	300	15X20X8'6	15	10	10	10	8	20	12
<b>STARSLIDE</b>	440	27X17X8'6	X	24	12	X	X	X	X
<b>WINDWOOD</b>	600	27X23X8'6	50	24	30	24	20	60	36
<b>FOXFIRE</b>	600	27X23X8'6	50	20	30	24	20	60	36

