

CONFERENCE ROOMS

COLORADO ROCKIES BALLROOM and COLUMBINE BALLROOM

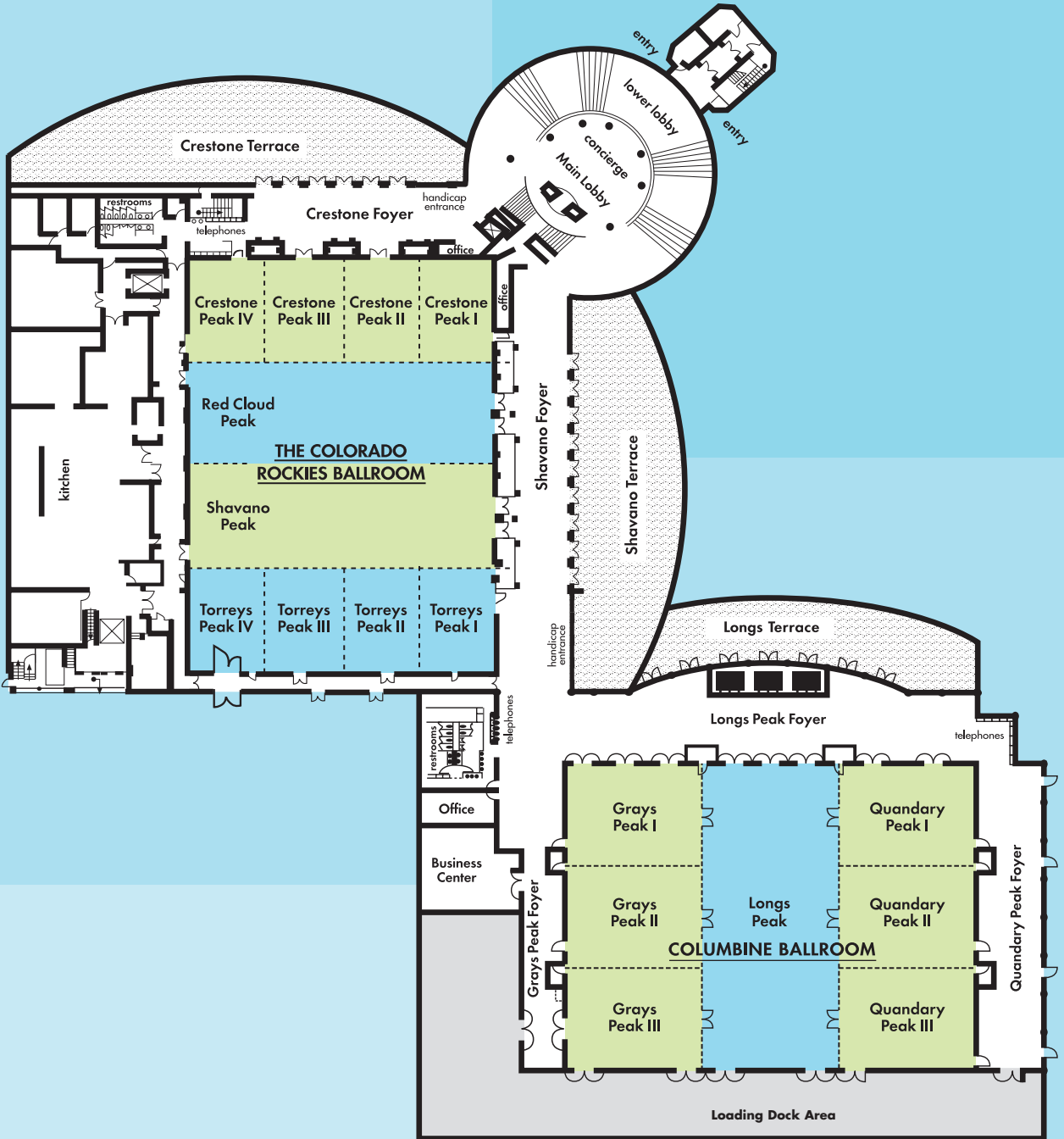

COLORADO ROCKIES EXHIBIT CAPACITIES

8X8 booths	8X10 booths	10X10 booths
120	104	92

COLUMBINE BALLROOM EXHIBIT CAPACITIES

8X8 booths	8X10 booths	10X10 booths
150	125	100

CONFERENCE ROOMS

KEYSTONE LODGE MEETING ROOMS (2nd Floor)

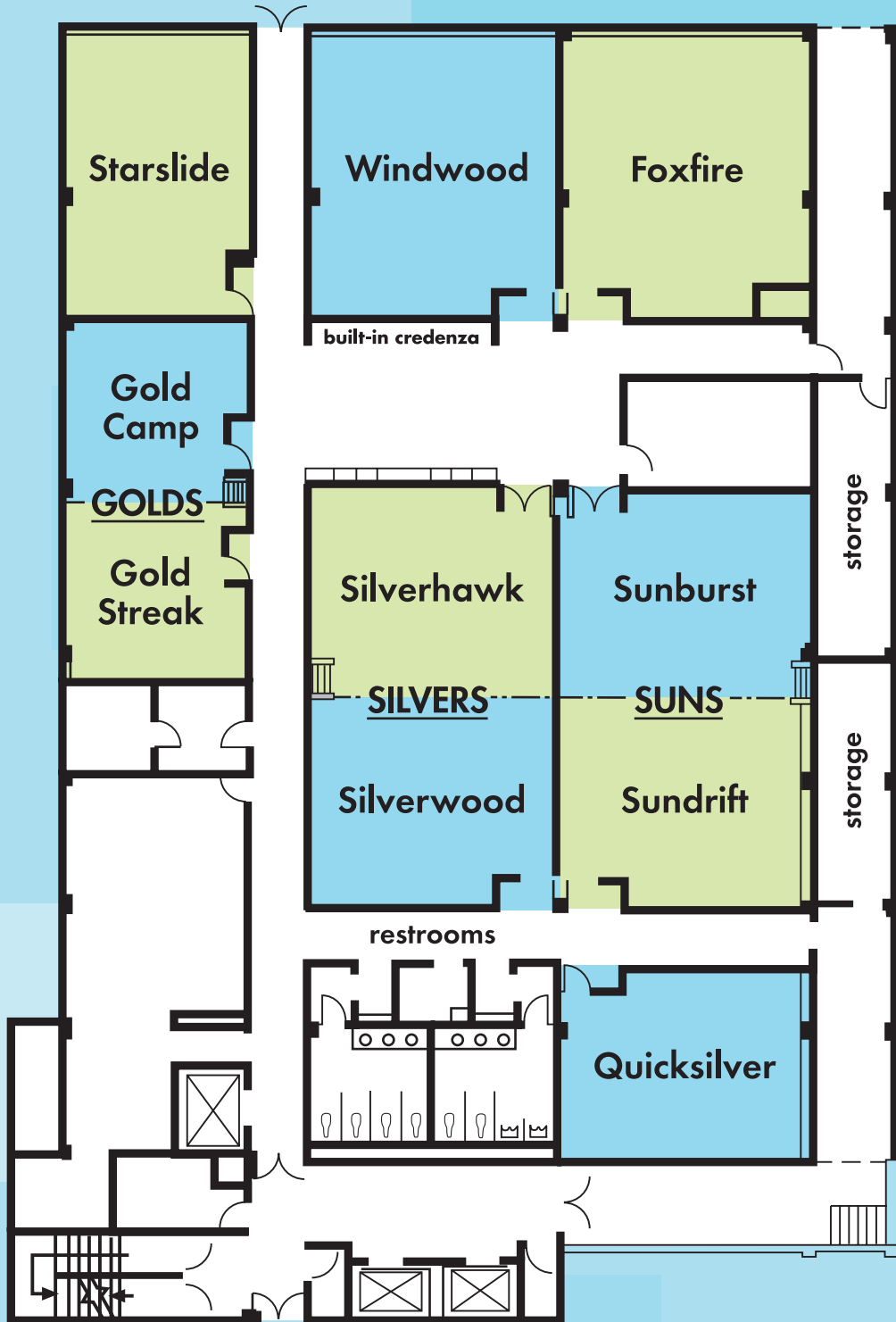

CONFERENCE ROOMS

WWW.KEYSTONECONFERENCES.COM

	Square Footage	Dimensions LxWxH	Theater	Schoolroom	Conference	Hollow Square	U-Shape	Reception	Dining
GOLDS	580	34x17x8'6	30	16	16	16	12	40	36
GOLDCAMP	290	17x17x8'6	12	8	8	8	6	20	12
GOLDSTREAK	290	17x17x8'6	12	48	8	8	6	20	12
SILVERS	920	40x23x8'6	90	48	30	40	32	95	60
SILVERHAWK	460	20x23x8'6	40	24	16	16	12	45	24
SILVERWOOD	460	20x23x8'6	40	24	16	16	12	45	24
SUNS	920	40x23x8'6	90	48	30	40	32	95	60
SUNBURST	460	20x23x8'6	40	24	16	16	12	45	24
SUNDRIFT	460	20x23x8'6	40	24	16	16	12	45	24
QUICKSILVER	300	15x20x8'6	15	10	10	10	8	20	12
STARSLIDE	440	27x17x8'6	X	24	12	X	X	X	X
WINDWOOD	600	27x23x8'6	50	24	30	24	20	60	36
FOXFIRE	600	27x23x8'6	50	20	30	24	20	60	36

CONFERENCE CENTER

2

FLOOR DIAGRAMS / CAPACITY CHARTS

6

AUDIO VISUAL PRICING / SHIPPING

16

BANQUET MENUS

20

WELCOME AMENITIES

51

ACCOMMODATIONS

54

RESORT ACTIVITIES

61



CONFERENCE ROOMS

KEYSTONE INN MEETING ROOMS

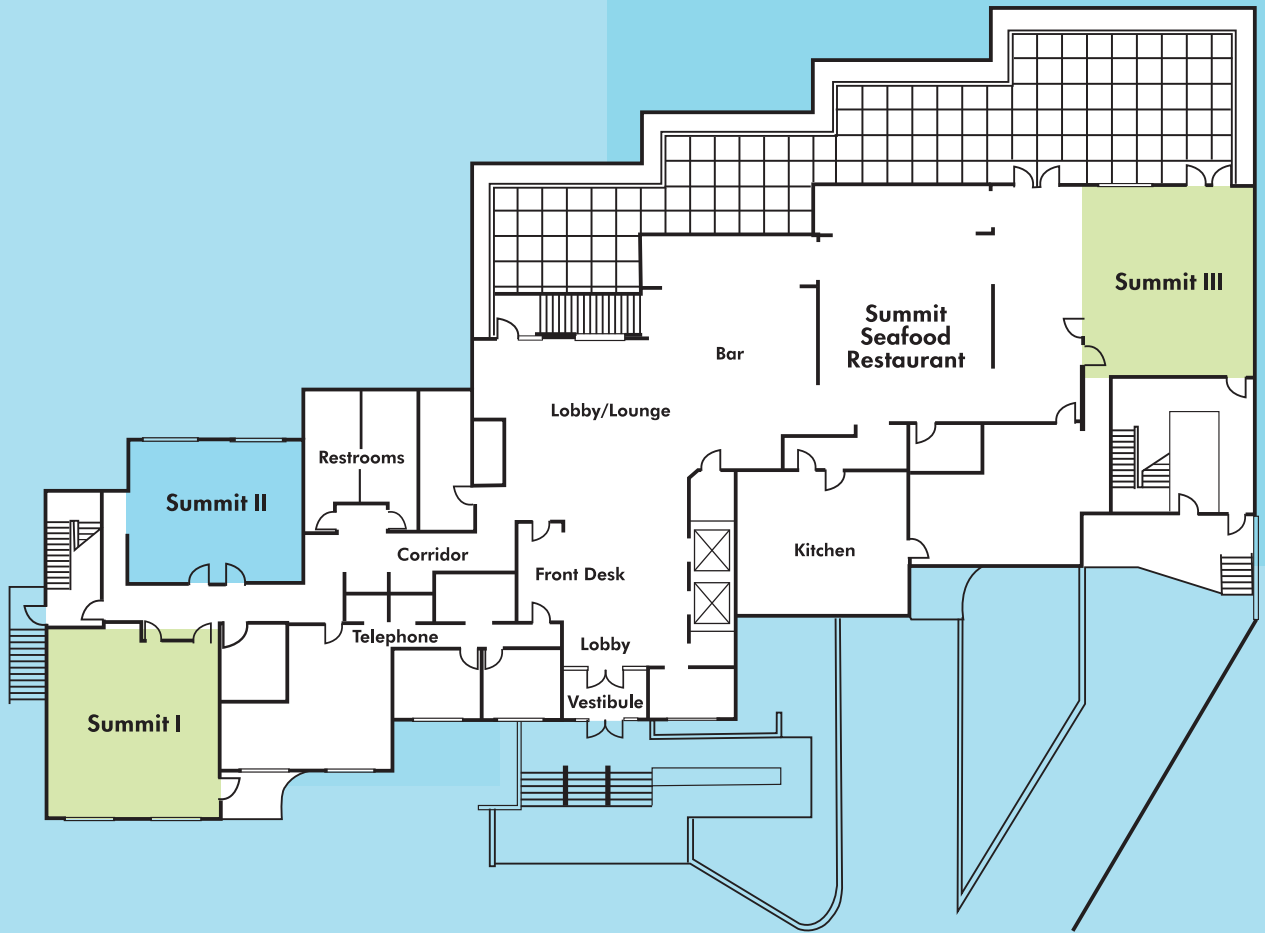

	Square Footage	Dimensions LxWxH	Theater	Schoolroom	Conference	Hollow Square	U-Shape	Reception	Dining
SUMMIT I	760	28x27x8	85	48	34	34	25	90	56
SUMMIT II	620	27x23x8	60	40	25	25	20	65	40
SUMMIT III	810	30x27x8	90	55	38	38	33	95	72

Also available within walking distance but not shown in diagram:

GATEWAY MEETING ROOM	1000	50x20x9	110	48	30	40	35	100	56
-----------------------------	------	---------	-----	----	----	----	----	-----	----

CONFERENCE ROOMS

KEYSTONE LODGE BALLROOM (3rd Floor)

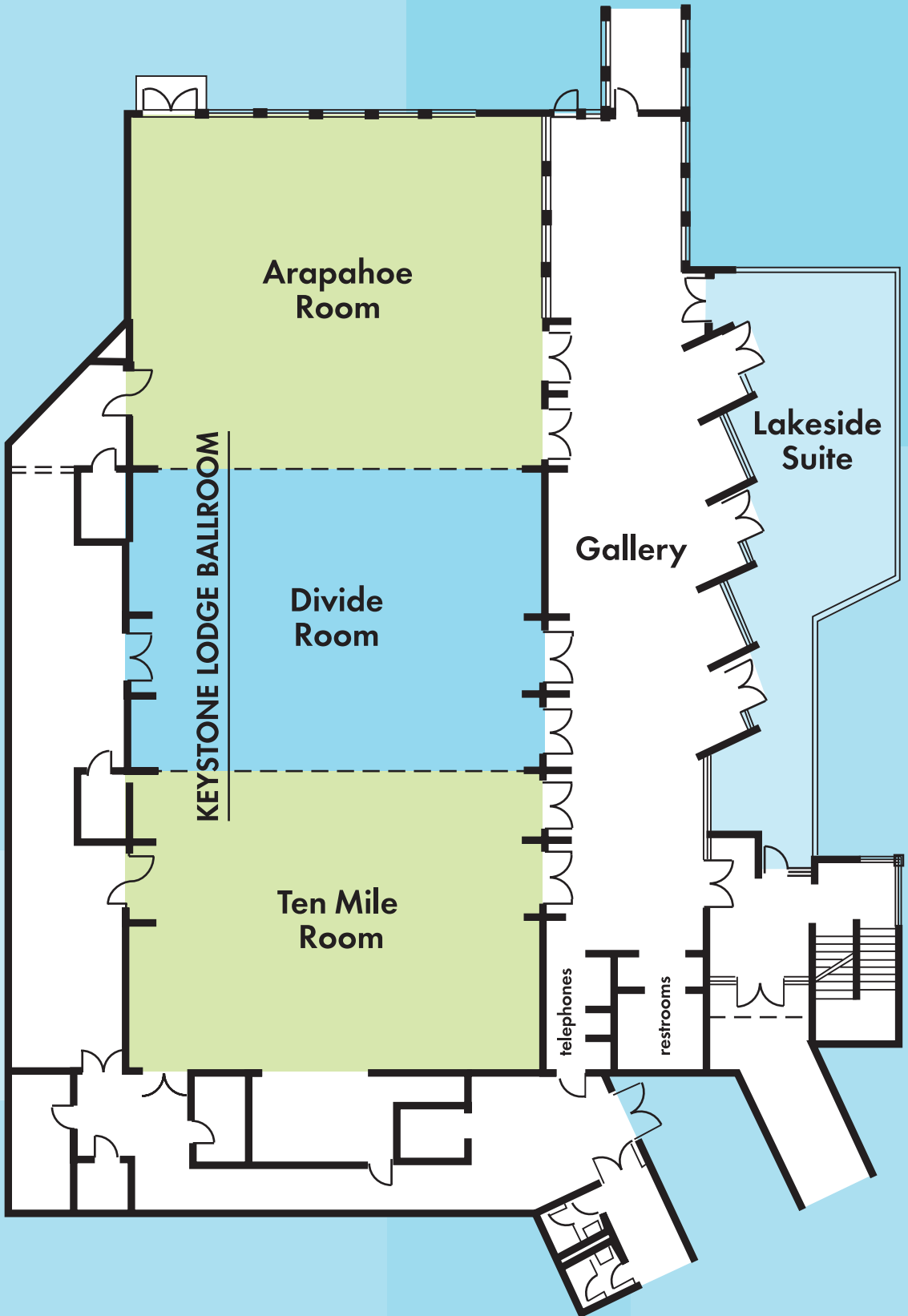

CONFERENCE ROOMS

CASTLE PEAK MEETING ROOMS (2nd Floor)

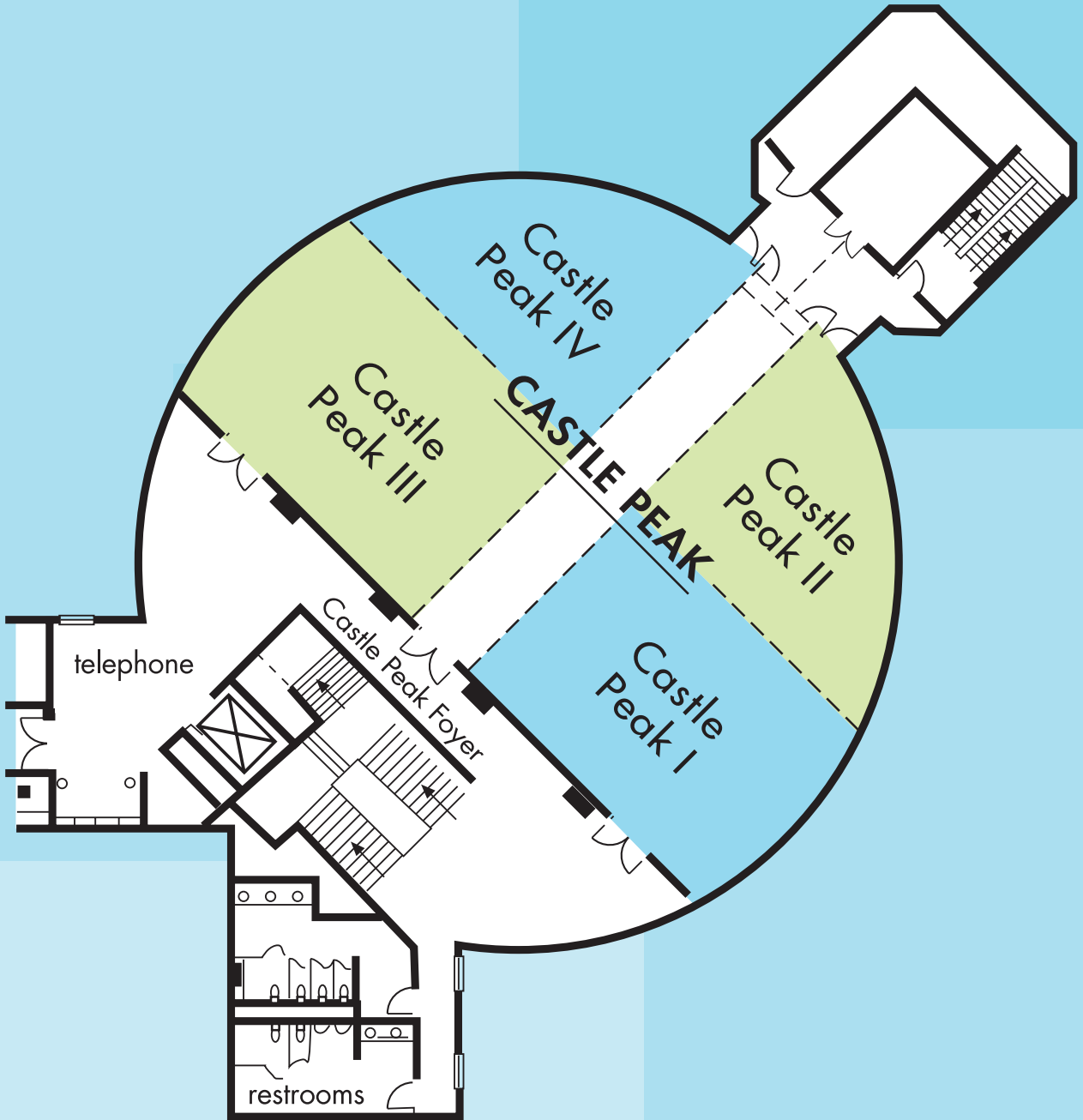

BOARDROOM/ROOF TOP PATIO, BELVEDERE (3rd Floor)

	Square Footage	Dimensions LxWxH	Theater	Schoolroom	Conference	Hollow Square	U-Shape	Reception	Dining Rounds of 12 people
CASTLE PEAK	3950	ROUND	400	176	X	X	X	400	324
CASTLE PEAK I	1000	25x37x9'10	120	45	36	36	30	120	72
CASTLE PEAK II	700	23x34x9'10	60	24	20	24	20	60	48
CASTLE PEAK III	1000	25x37x9'10	120	45	36	36	30	120	72
CASTLE PEAK IV	700	23x34x9'10	60	24	20	24	20	60	48
CASTLE PEAK FOYER	1350	x	x	x	x	x	x	130	x
BELVEDERE	3950	x	x	x	x	x	x	400	288
BOARDROOM	480	x	x	x	16	x	x	x	x

