

	JAN	FEB	MAR	APR	MAY	JUN	JUL	AUG	SEP	OCT	NOV	DEC
HI F° (C°)	30 (-1.1)	32 (0.0)	43 (6.1)	56 (13.3)	68 (20)	78 (25.5)	82 (27.7)	80 (26.6)	72 (22.2)	60 (15.5)	47 (8.7)	35 (1.6)
LO F° (C°)	16 (-8.0)	18 (-7.7)	27 (-2.7)	37 (2.7)	47 (8.3)	57 (13.8)	63 (17.2)	61 (16.1)	54 (12.2)	43 (6.1)	33 (0.5)	22 (-5.5)

POPULAR SITES AND ATTRACTIONS

- Cobo Center (.8 miles)
- GM Renaissance Center (1.2 miles)
- Hart Plaza (1 mile)
- The Henry Ford (12.3 miles)
 - Greenfield Village
 - Henry Ford Museum
- Belle Isle
- Edsel and Eleanor Ford House Tour
- Motown Museum
- Museum of African American History
- The Detroit Institute of Arts
- The Detroit Science Center
- The Detroit Zoo

SPORTING / ENTERTAINMENT VENUES

Downtown Area

- Joe Louis Arena
- Ford Field
- Comerica Park
- Chene Park
- Detroit Opera House / Michigan Opera Theatre
- Fisher Theatre
- Gem Theatre
- Masonic Temple
- The Fox Theatre
- The Max M. Fisher Music Center
- The State Theatre

Metropolitan Area

- DTE Energy Music Theatre
- Meadow Brook Theatre
- The Palace of Auburn Hills



AIRPORTS

- Detroit Metropolitan Airport
18 miles / 25 minutes average by automobile
- Coleman A. Young International Airport (Detroit City Airport)
6 miles / 10 minutes average by automobile
- Oakland County International Airport, Pontiac, MI
38 miles / 45 minutes average by automobile

ADDITIONAL INFORMATION

- Detroit Metro Convention and Visitors Bureau
www.visitdetroit.com
- Detroit Regional Chamber
www.detroitchamber.com



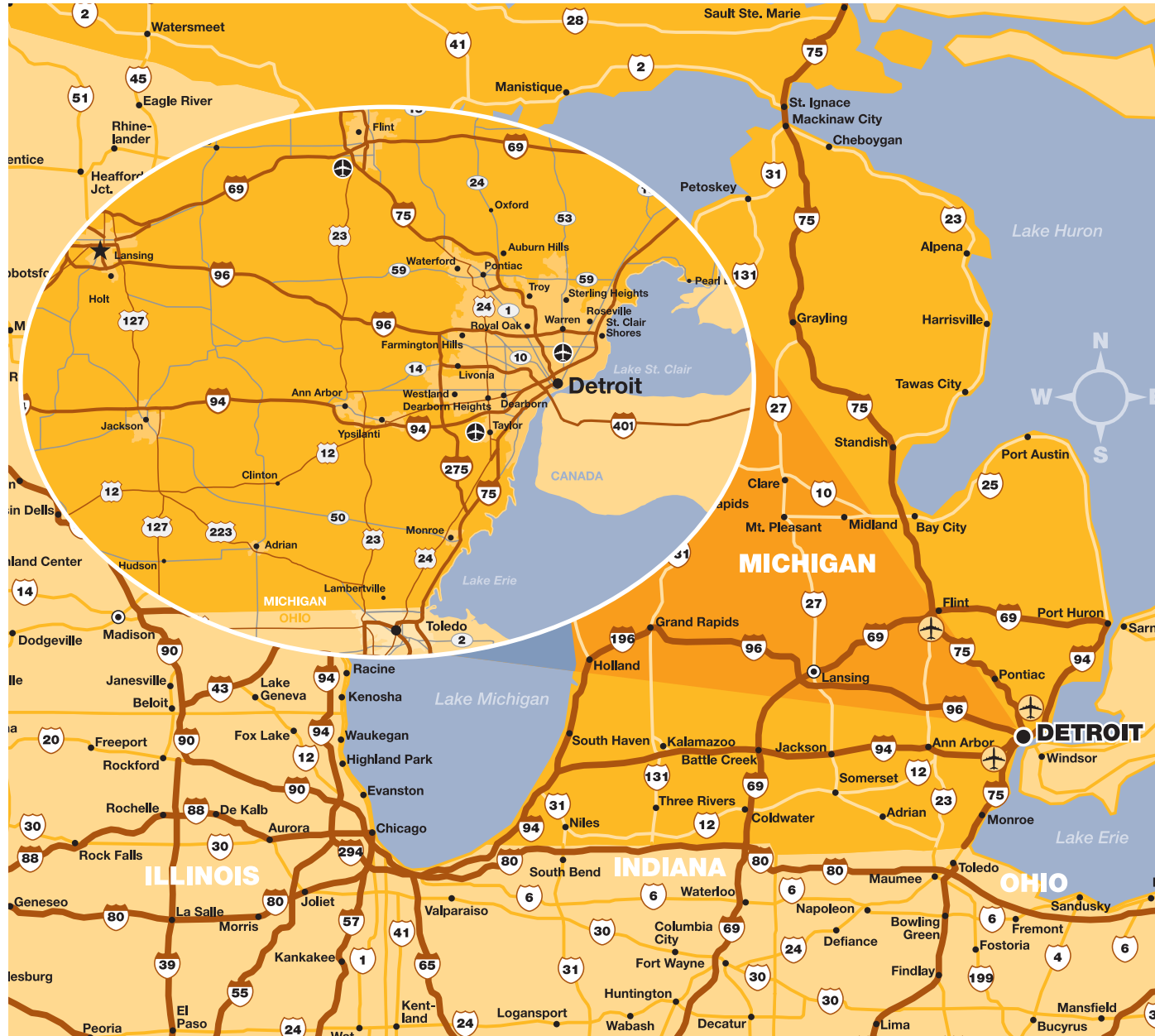

DIRECTIONS TO MGM GRAND DETROIT

- **From Detroit Metropolitan Airport:**
Take I-94 East to M-10 South, exit left at Bagley Ave. Turn left on Third Street.
- **From Ambassador Bridge:**
After crossing the bridge, follow I-75 North. Continue on I-75 North to M-10 South. Take M-10 South to Howard Street exit. Turn left at Howard Street. Turn left on Third Street.
- **From Detroit-Windsor Tunnel:**
After exiting the tunnel, turn right (East) on to Jefferson Ave. and then immediately loop around to head West on Jefferson Ave. Continue Westbound on Jefferson Ave. to Northbound Woodward Ave. Turn left on Michigan Ave. Turn right on Third Street.
- **From the North:** Take I-75 South to I-94 West to M-10 South. Exit left at Bagley Ave. Turn left on Third Street.
- **From the South:** Take I-75 North to M-10 South. Exit Howard Street and turn left. Turn left on Third Street.
- **From the East:** Take I-94 West to M-10 South. Exit left at Bagley Ave. Turn left on Third Street.
- **From the West:** Take I-96 East to I-94 East to M-10 South. Exit left at Bagley Ave. Turn left on Third Street.

THE HEIGHT OF LUXURY IN DOWNTOWN DETROIT

MGM Grand Detroit has the chic comfort of a world-class hotel destination with the luxury amenities for today's professional traveler. Be relaxed and pampered in any of our 400 stylish guest rooms and suites, and then step out into Detroit's coolest scene.

- Private hotel entrance
- Exclusive Concierge level with full service lounge
- Lobby Living Room for hotel guests only
- Full service resort style spa and salon, indoor pool and state-of-the-art fitness center
- 24-hour full service in-room dining
- 24-hour valet and complimentary covered self-parking
- 335 oversized guest rooms - 435 sq. ft. — 605 sq. ft.
- 65 spacious luxury suites including:
 - 56 Corner Suites with city or skyline views - 850 sq. ft.
 - 9 Rooftop VIP Suites comprised of:
 - Executive Suites - 880 sq. ft.
 - Penthouse Suites - 1,290 sq. ft.
 - Grand Penthouse Suites - 1,680 sq. ft. — 1,920 sq. ft.

Modern technology features include high-speed wireless Internet, large plasma screens, "technology butler" telephones with direct 'do not disturb' communications.

All guest rooms and suites feature pillowtop beds with white-on-white high thread count linens, microfiber bathrobes and evening turndown service.

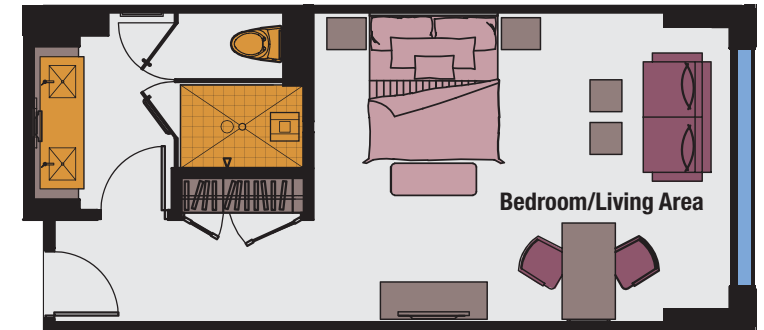

Deluxe King

435 sq. ft.
1 bedroom / 1 bath

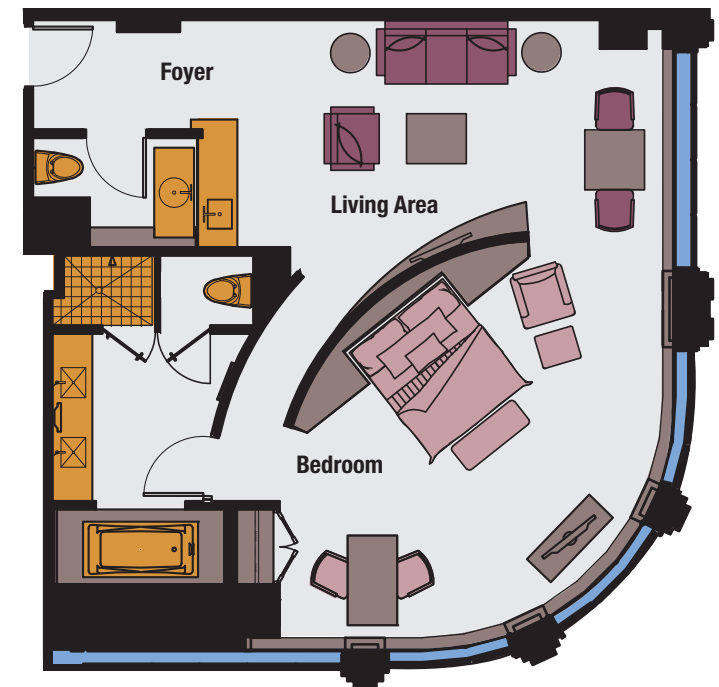

Corner Suite

850 sq. ft.
1 bedroom / 1.5 baths

Penthouse Suite

1,290 sq. ft.
1 bedroom / 1.5 baths

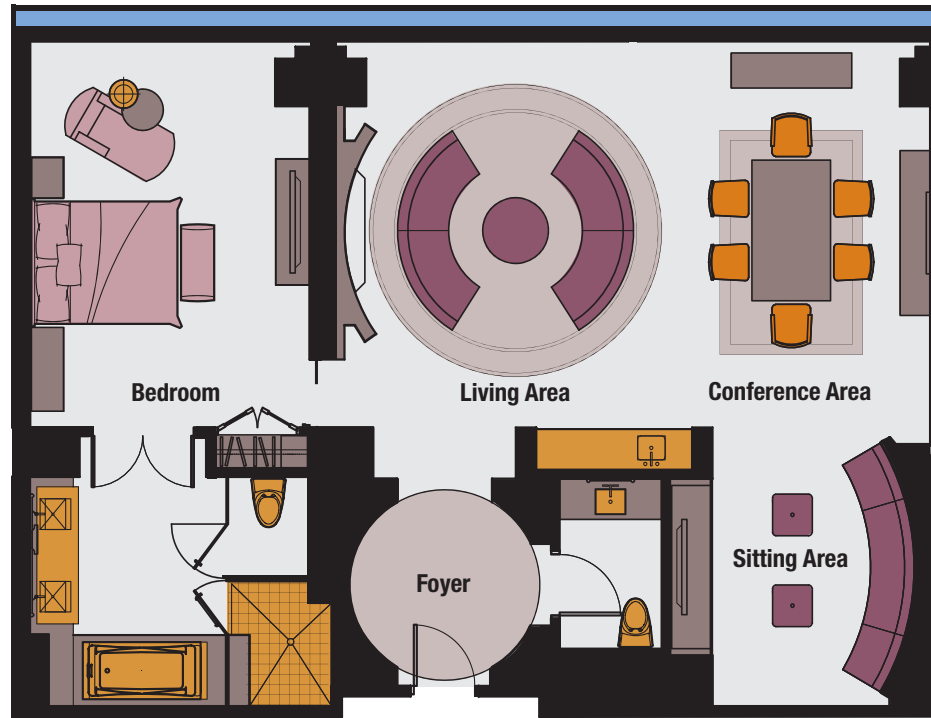

Grand Penthouse Suite

1,920 sq. ft.
2 bedrooms / 2.5 baths

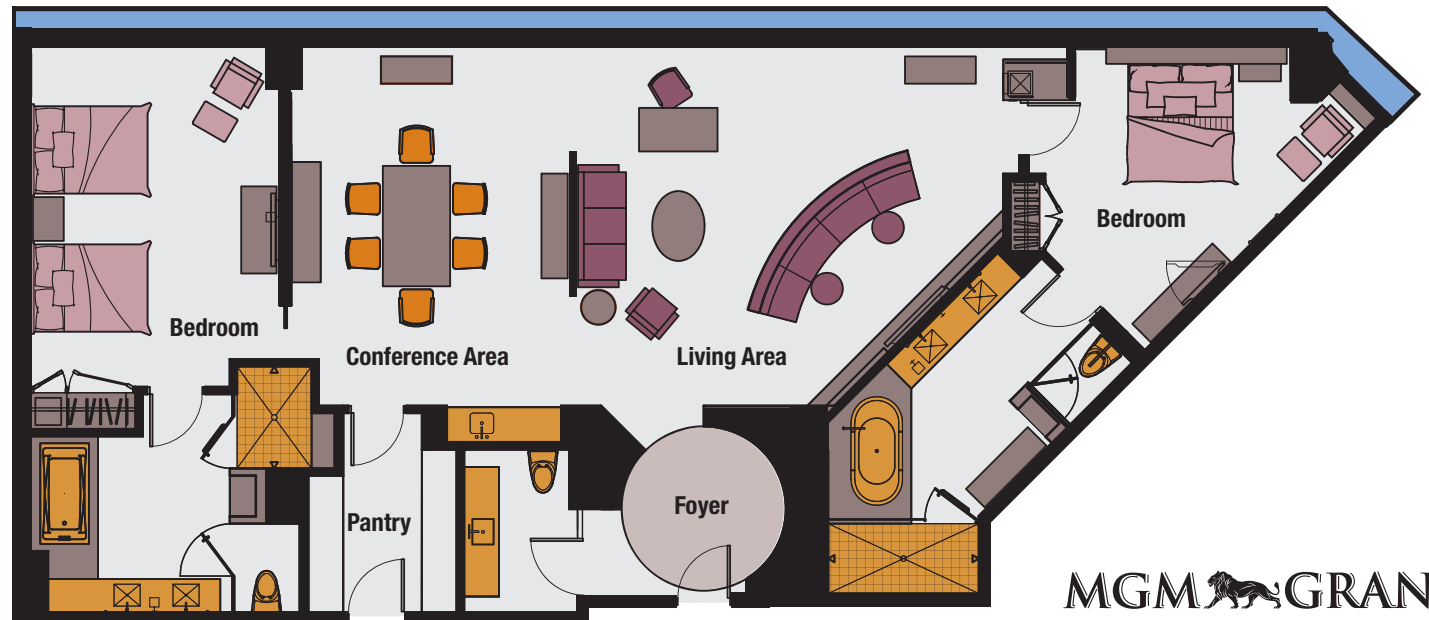



THE CENTER FOR ANY EVENT

Business or pleasure? Now you can have both. From large corporate events to intimate black-tie engagements, MGM Grand Detroit will cater to your every whim. So whether you want to inspire a large group, motivate a small team or celebrate a milestone event, MGM Grand Detroit will leave a lasting impression.

- 30,000 sq. ft. of functional event space accommodating private parties, conferences and events up to 1,200
- Grand Ballroom opens to 14,000 sq. ft. or divides into four Ballroom Salons
- 3 Meeting Rooms (Amber, Garnet and Sapphire) 1,600 sq. ft. each divide in half - accommodates up to 90 people each
- 2 Executive Boardrooms (Onyx and Quartz) 710 sq. ft. - accommodates up to 18 people each

MEETINGS AND EVENTS CENTER CAPACITY

MGM Grand Detroit	Dimensions	Square Feet	Ceiling Height	Theatre	Classroom	U-Shape	Banquet Rounds	Reception	Conference
Grand Ballroom	107' x 131'	14,020	21'	1,200	900	–	900	1,200	–
Grand Salons 1 or 3	58' x 54'	3,130	21'	280	160	58	160	300	64
Grand Salons 2 or 4	54' x 49'	2,650	21'	250	140	44	140	260	52
Grand Salons 1 & 2 or 3 & 4	107' x 54'	5,780	21'	560	400	–	400	600	–
with Grand Aisle	107' x 74'	7,920	21'	800	580	–	580	900	–
Grand Aisle	107' x 20'	2,140	21'	–	–	–	–	–	–
Grand Foyer	156' x 26'	4,060	–	–	–	–	120	300	–
Amber, Garnet and Sapphire Rooms	48' x 33'	1,600	12'	90	60	36	60	110	42
Breakout 1	33' x 24'	790	12'	34	24	16	24	40	18
Breakout 2	33' x 24'	790	12'	34	24	16	24	40	18
Onyx and Quartz Boardroom	31' x 23'	710	12'	–	–	–	–	–	18

NIGHTLIFE SO HOT IT GIVES YOU CHILLS

Go beyond the threshold of excitement with the hottest nightlife at MGM Grand Detroit. Heighten your senses as the rhythm of intoxicating music flows from five unique lounge experiences. Get ready to ignite your senses in surroundings beyond compare.



V

As the sun sets, the heat rises at V.

- Two elevated areas overlooking floor
- Interactive lightshow
- Luxury brand cocktails
- Accommodates up to 300, Private Bar accommodates up to 29



IGNITE

From our intimate fire pit to our modern decor, get ready to “Ignite” your senses.

- Private elevator access
- Premium selection of whiskeys, scotches and cognacs, including Woodford Reserve and Knob Creek bourbons and selected vodkas
- Collection of the world’s finest cigars
- Seats up to 250, Private Cigar Room seats 12-16



U ME DRINK

Step inside our center lounge and surround yourself in an interactive environment that’s constantly evolving to enhance your mood and elevate your game.

- Specialty “mood” cocktail menu
- Fine wines by the glass, from Chile and Argentina
- Interactive projections by legendary Cirque Du Soleil designer, Rouge



INT ICE

The cozy piano lounge atmosphere and sophisticated furnishings make INT ICE the premium lounge where business and pleasure meet.

- Order a classic sidecar, pink lady or gimlet with a modern twist
- Large selection of single malt scotches and cognacs



AGUA

Surround yourself in aquatic ambiance where every moment feels like an underwater escape.

- South American music flows throughout
- Over 20 selections of tequila and rum
- Infused signature margaritas, caipirinhas and mojitos

SATISFY EVERY CRAVING IMAGINABLE

Indulge in a garden of earthly delights with three signature restaurants from Wolfgang Puck and Michael Mina. Add to that our creative new tapas concept Palette Dining Studio and a quick serve area and prepare to satisfy every craving imaginable.



B O U R B O N S T E A K

BOURBON STEAK

Michael Mina brings his steakhouse concept to Detroit with BOURBON STEAK. Through his modern twist on a classic steakhouse menu, lively bar and contemporary atmosphere, BOURBON STEAK plays host to guests looking for the perfect filet in a modern steakhouse setting. Seating up to 82 total.

- Chef's table seats 8
- Semi Private Dining seats up to 8
- Private Dining Room seats 44



S A L T W A T E R

SALTWATER

Michael Mina's opulent seafood dining experience at MGM Grand Detroit, SALTWATER, features contemporary seafood and refined American cuisine set in an elegant design that celebrates the richness of the sea. Seating up to 90 total.

- Private Dining Room seats 10 (circular table)
- Wine Tasting Table seats 12



WOLFGANG PUCK GRILLE

A contemporary twist on the traditional 'bar & grill' concept, America's first celebrity chef, Wolfgang Puck, features modern American cuisine at his namesake restaurant: the WOLFGANG PUCK GRILLE. Discover Puck's signature dishes using his trademark standards for creating innovative tastes with fresh, all-natural and organic ingredients at a range of prices to accommodate varying budgets.

- Seating up to 181
- Private Dining available-Wolfgang's Kitchen Table (seats up to 16)



PALETTE DINING STUDIO

Discover your creative side at Palette Dining Studio. Indulge in a full spectrum of freshly designed dishes in our unique, all-you-can-eat tapas style gallery, where every creation is a sumptuous canvas of color, texture and taste.



BREEZE

For a quick bite on the go, "Breeze" into our quick serve area and discover five distinct dining experiences that come together in perfect harmony to lift your spirit and keep your momentum going!