



MEETINGS AND EVENTS

Vast. Expansive. Beyond imagination. Atlantis lays claim to the largest ballroom in the Caribbean and provides the perfect setting for truly memorable events. The new world-class conference center features a 50,000-square-foot Imperial Ballroom and over 30,000 square feet of pre-function space, including 26 breakout rooms, two boardrooms and a large staging area. At The Cove Atlantis, two new executive boardrooms are surrounded in sophistication and offer the latest technology.

ATLANTIS
PARADISE ISLAND, BAHAMAS™



1
TO OCEAN CLUB
GOLF COURSE

HARBORSIDE
RESORT

MARINA
VILLAGE

ATLANTIS
MARINA

CONFERENCE
CENTER

CORAL TOWERS

ROYAL TOWERS

DOLPHIN
CAY

RESIDENCES
AT ATLANTIS

THE COVE
ATLANTIS

BEACH
TOWER

2

3

5

4

6

6

8

7

9

11

13

14

12

21

15

16

17

18

19

20

OUTDOOR EVENT SPACE

NUMBER	LOCATION	RECEPTION CAPACITY	BANQUET CAPACITY
1	Ocean Club Golf Course	-	-
2	Cave Grill	250	150
3	River Pool Deck	1,400	1,000
4	Seagrapes Overlook	100	75
5	Beach Bar	100	-
6	Lagoon Pool Deck	1,100	500
7	Water's Edge Patio	100	50
8	Lagoon Bar & Grill	100	60
9	Dragons Patio	100	50
10	West Beach	900	600
11	Dig Deck	800	450
12	Royal Deck	1,000	700
13	Royal Overlook	60	40
14	Dive In	350	200
15	Grotto Pool Deck	1,500	1,050
16	Ripples	900	600
17	The Baths Island	1,400	1,000
18	The Baths Colonnade	250	150
19	Cove Beach	300	200
20	Dolphin Cay Beach	280	200
21	Mayan Dune	300	200

*To book an event beyond any other,
call 1.800.722.2449 or visit Atlantis.com.*

ATLANTIS
PARADISE ISLAND, BAHAMAS™

ATLANTIS
CONFERENCE CENTER

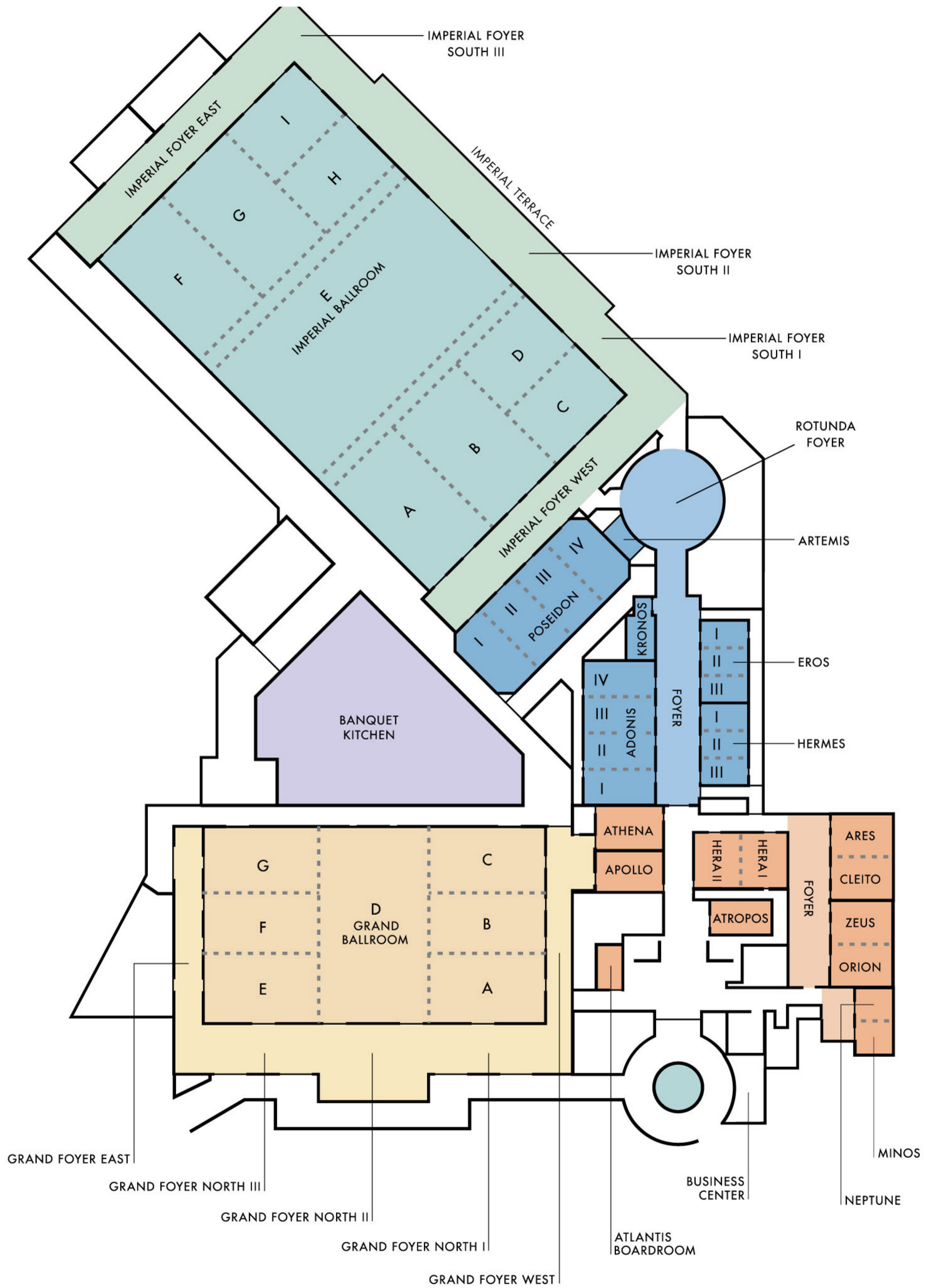

GRAND	Square Feet	Room Dimensions	Ceiling Height	Reception	Banquet	Theater-style	School Rm.-style	Conference Style	Trade Show Booth 10' x 10'	Trade Show Booth 8' x 10'
Grand Ballroom	24,804	212' x 115'	23'6"	2,700	1,840	2,070	1,200	-	125	156
Ballroom A	2,808	72' x 38'	23'6"	310	210	235	140	-	14	18
Ballroom B	2,808	72' x 38'	23'6"	310	210	235	140	-	14	18
Ballroom C	2,808	72' x 38'	23'6"	310	210	235	140	-	14	18
Ballroom (ABC)	8,424	72' x 115'	23'6"	935	620	700	400	-	43	53
Ballroom D	7,956	68' x 115'	23'6"	890	590	660	380	-	40	50
Ballroom E	2,808	72' x 38'	23'6"	310	210	235	140	-	14	18
Ballroom F	2,808	72' x 38'	23'6"	310	210	235	140	-	14	18
Ballroom G	2,808	72' x 38'	23'6"	310	210	235	140	-	14	18
Ballroom (EFG)	8,424	72' x 115'	23'6"	935	620	700	400	-	43	53
Grand Foyer	13,618	-	16'	1,400	-	-	-	-	-	-
Grand Foyer North I, II & III	7,068	212' x 33'	16'	200	-	-	-	-	-	-
Grand Foyer North I	2,106	70' x 28'	16'	325	-	-	-	-	-	-
Grand Foyer North II	2,856	68' x 42'	16'	200	-	-	-	-	-	-
Grand Foyer North III	2,106	70' x 28'	16'	350	-	-	-	-	-	-
Grand Foyer East	3,100	156' x 20'	16'	375	-	-	-	-	-	-
Grand Foyer West	3,450	150' x 22'	16'	725	-	-	-	-	-	-
Atropos	540	18' x 30'	9'	60	40	45	26	18	-	-
Apollo	1,121	41'6" x 27'	12'	125	90	85	50	36	-	-
Athena	1,104	41'6" x 27'	12'	125	90	85	50	36	-	-
Hera I	945	28' x 33'	10'	105	70	80	42	30	-	-
Hera II	968	29' x 33'	10'	105	70	80	42	30	-	-
Hera I & II	1,913	57' x 33'	10'	210	140	155	90	-	-	-
Minos	462	22' x 21'	10'	50	40	40	22	15	-	-
Neptune	462	22' x 21'	10'	50	40	40	22	15	-	-
Minos & Neptune	924	22' x 42'	10'	100	70	80	44	30	-	-
Orion	945	35' x 27'	10'	105	70	80	45	30	-	-
Zeus	945	35' x 27'	10'	105	70	80	45	30	-	-
Orion & Zeus	1890	35' x 52'	10'	210	140	160	90	-	-	-
Cleito	893	35' x 25'6"	12'	100	70	75	45	30	-	-
Ares	945	35' x 27'	12'	100	70	75	45	32	-	-
Ares & Cleito	1,838	35' x 53'	12'	200	130	150	90	-	-	-
Atlantis Boardroom	415	14' x 22'	10'	-	-	-	-	12*	-	-

IMPERIAL	Square Feet	Room Dimensions	Ceiling Height	Reception	Banquet	Theater-style	School Rm.-style	Conference Style	Trade Show Booth 10' x 10'	Trade Show Booth 8' x 10'
Imperial Ballroom (A-I)	50,000	289' x 165'	26'	5,300	3,500	3,975	2,380	-	240	300
Ballroom A	5,052	55'6" x 88'	26'	560	370	420	240	-	26	32
Ballroom B	4,844	55'6" x 88'	26'	540	360	400	230	-	24	30
Ballroom C	2,684	61' x 44'	26'	300	200	220	125	-	13	17
Ballroom D	2,445	55'6" x 44'	26'	275	180	200	115	-	12	15
Ballroom (ABCD)	15,062	88' x 171'	26'	1,675	1,100	1,250	710	-	76	95
Ballroom E	15,903	93'6" x 166'6"	26'	1,775	1,180	1,325	760	-	80	100
Ballroom F	5,052	55'6" x 88'	26'	560	370	420	240	-	26	32
Ballroom G	4,844	55'6" x 88'	26'	540	360	400	230	-	24	30
Ballroom H	2,445	55'6" x 44'	26'	275	180	200	115	-	12	15
Ballroom I	2,684	61' x 44'	26'	300	200	125	125	-	13	17
Ballroom (FGHI)	15,062	88' x 171'	26'	1,675	1,100	1,250	710	-	76	95
Imperial Foyer South I, II & III	8,773	-	16'	975	-	-	-	-	44	55
Imperial Foyer South I	2,734	-	15'	300	-	-	-	-	14	17
Imperial Foyer South II	3,303	-	17'	350	-	-	-	-	16	21
Imperial Foyer South III	2,736	-	15'	300	-	-	-	-	14	17
Imperial Foyer East	5,686	-	15'	635	-	-	-	-	29	36
Imperial Foyer West	5,645	-	15'	625	-	-	-	-	29	36
Imperial Terrace				1000						
Hermes I	493	29' x 17'	12'	55	40	40	24	18	-	-
Hermes II	493	29' x 17'	12'	55	40	40	24	18	-	-
Hermes III	493	29' x 17'	12'	55	40	40	24	18	-	-
Hermes I, II & III	1,479	29' x 51'	12'	170	110	125	70	48	-	-
Eros I	493	29' x 17'	12'	55	40	40	24	18	-	-
Eros II	493	29' x 17'	12'	55	40	40	24	18	-	-
Eros III	493	29' x 17'	12'	55	40	40	24	18	-	-
Eros I, II & III	1,479	29' x 51'	12'	170	110	125	70	48	-	-
Adonis I	957	44'6" x 21'6"	12'	140	70	105	45	32	-	-
Adonis II	957	44'6" x 21'6"	12'	140	70	105	45	32	-	-
Adonis III	957	44'6" x 21'6"	12'	140	70	105	45	32	-	-
Adonis IV	957	44'6" x 21'6"	12'	140	70	105	45	32	-	-
Adonis I, II, III & IV	3,828	44'6" x 86'	12'	425	280	325	180	-	-	-
Poseidon I	1,332	28' x 48'	12'	150	100	115	65	44	-	-
Poseidon II	1,392	29' x 48'	12'	155	110	120	70	48	-	-
Poseidon III	1,392	29' x 48'	12'	155	110	120	70	48	-	-
Poseidon IV	1,332	28' x 48'	12'	150	100	115	65	44	-	-
Poseidon I, II, III & IV	5,448	116' x 48'	12'	600	400	450	260	-	-	-
Kronos	504	28' x 18'	10'	-	-	-	-	12*	-	-
Artemis	420	30' x 14'	10'	45	30	35	20	14	-	-

*Boardroom table

ATLANTIS CONFERENCE CENTER FUNCTION SPACE

BEACH TOWER MEETING ROOMS

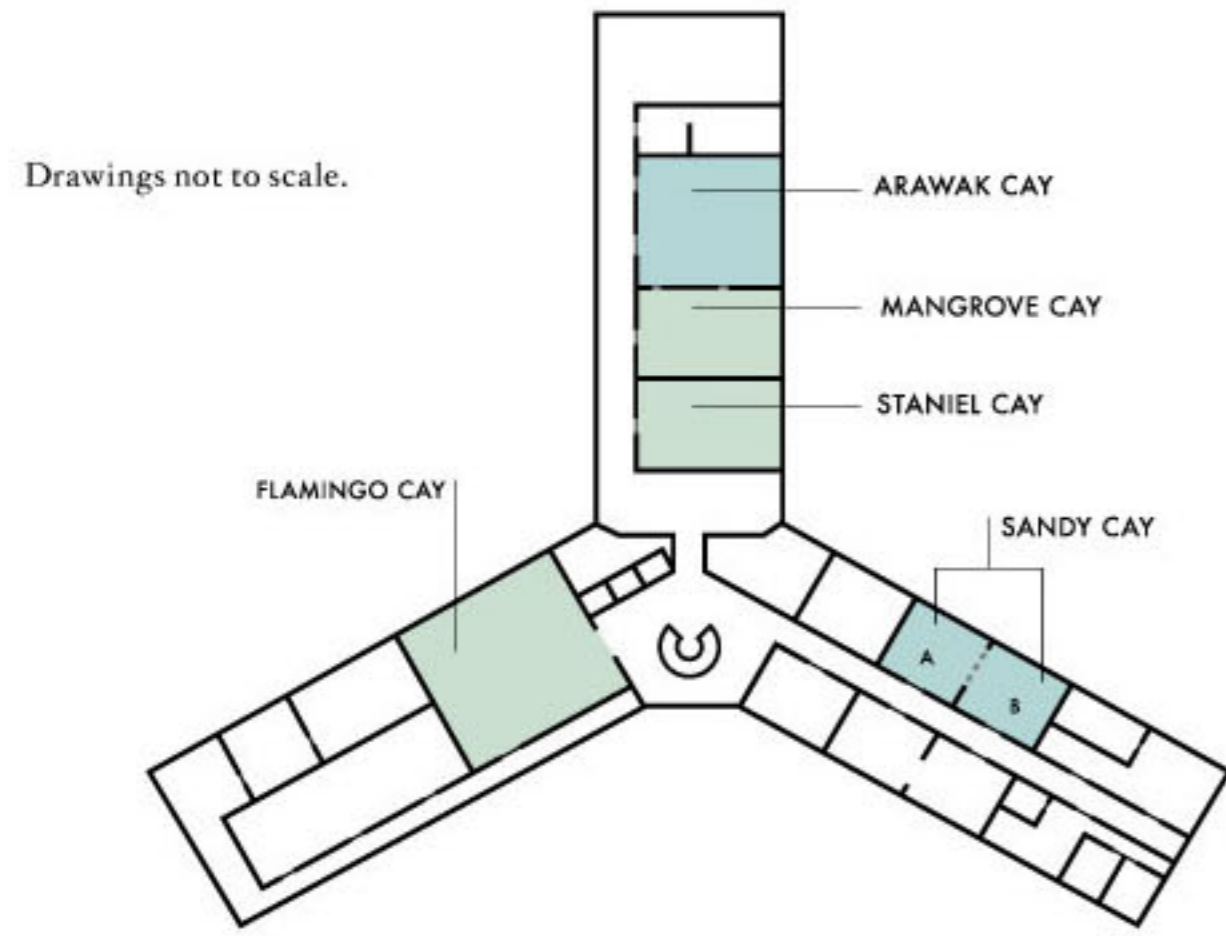

CROWN BALLROOM | BEACH TOWER

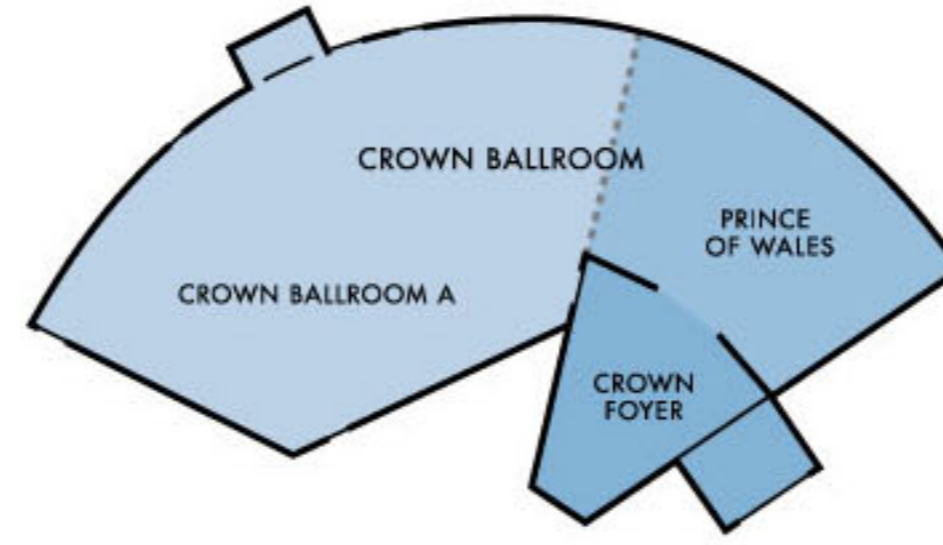

THE COVE ATLANTIS

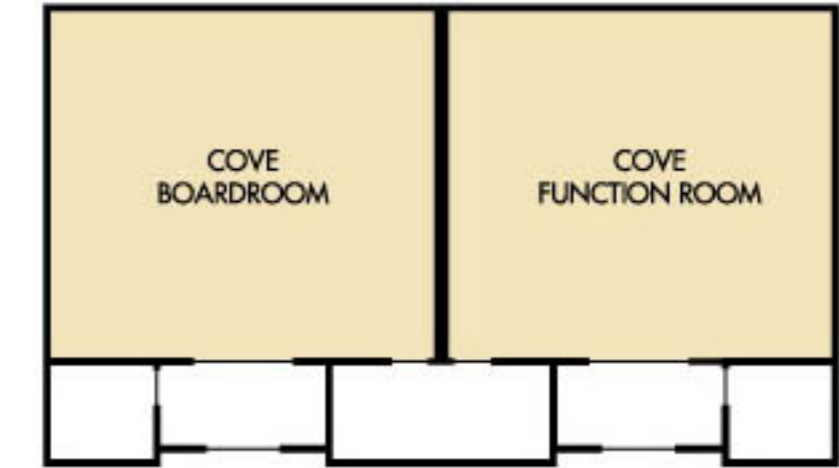

ATLANTIS FUNCTION SPACE	Square Feet	Room Dimensions	Ceiling Height	Reception	Banquet	Theater-style	School Rm.-style	Conference Style	Trade Show Booth 10' x 10'	Trade Show Booth 8' x 10'
CROWN BALLROOM BEACH TOWER										
Crown Ballroom	13,000	75' x 176'	14'	1,450	960	1,080	620	-	66	82
Prince of Wales	3,035	54' x 95'	14'	335	230	250	140	-	15	19
Crown Ballroom A	9,975	75' x 176'	14'	1,108	739	831	475	-	50	63
Crown Foyer	-	-	14'	-	-	-	-	-	-	-
BEACH TOWER MEETING ROOMS										
Flamingo Cay	2,907	-	8'6"	325	210	240	140	-	-	-
Arawak Cay	1,968	48' x 41'	8'4"	220	140	160	90	-	-	-
Mangrove Cay	1,344	48' x 28'	8'6"	150	100	115	60	45	-	-
Staniel Cay	1,344	48' x 28'	8'6"	150	100	115	60	45	-	-
Sandy Cay A	702	26' x 26'	9'4"	80	50	60	34	24	-	-
Sandy Cay B	702	26' x 26'	9'4"	80	50	60	34	24	-	-
Sandy Cay (AB)	1,404	26' x 52'	9'4"	150	100	115	60	45	-	-
ROYAL TOWERS										
Royal Boardroom I	516	29'6" x 17'6"	8'6"	-	-	-	-	16*	-	-
Royal Boardroom II	864	48' x 18'	8'6"	-	-	-	-	22*	-	-
Royal Hospitality I	294	21' x 14'	12'	-	-	-	-	-	-	-
Royal Hospitality II	294	21' x 14'	12'	-	-	-	-	-	-	-
Royal Hospitality III	294	21' x 14'	12'	-	-	-	-	-	-	-
THE COVE ATLANTIS										
Cove Boardroom	892	31'4" x 28'6"	11'	-	-	-	-	18*	-	-
Cove Function Room	883	30'10" x 28'6"	11'	-	-	-	-	-	-	-

*Boardroom table