

MEETING FACILITIES MAP

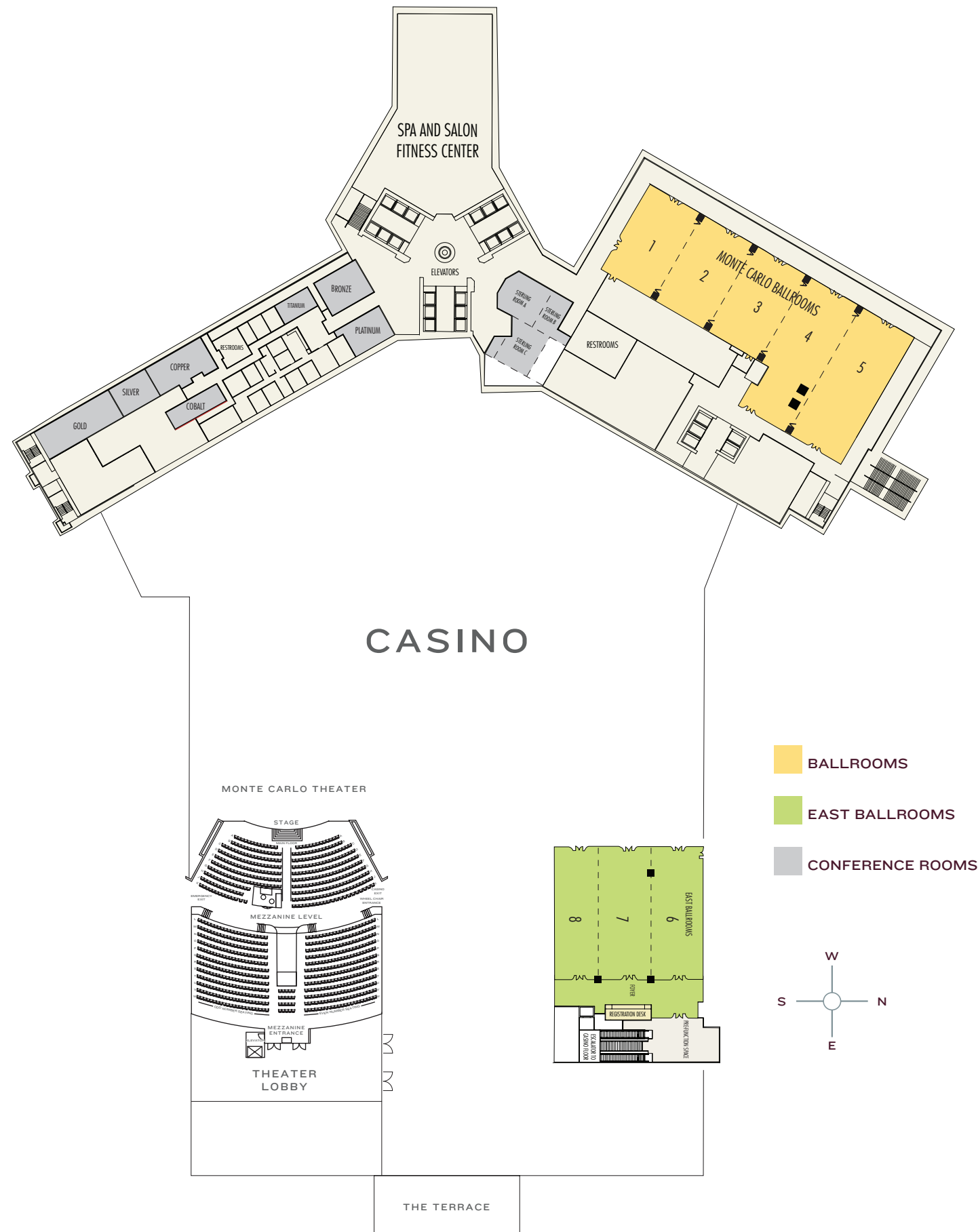

Monte Carlo

LAS VEGAS RESORT AND CASINO

UNPRETENTIOUSLY LUXURIOUS™

3770 Las Vegas Boulevard South
Las Vegas, NV 89109

GROUP SALES
800.311.5999 ■ 702.730.7300



MONTECARLO.COM

FLOOR PLANS AND CAPACITIES

Between a variety of floor plans and over 30,000 square feet of flexible meeting space, Monte Carlo has the perfect space to best fit the needs of your special event. Whether you're holding a meeting for eight or 800, all of our rooms are equipped to accommodate anything from the most elaborate business presentations to the most intimate of engagements. Let the details be handled in one of our rooms and enjoy your event as it unfolds seamlessly.

CAPACITIES AND DIMENSIONS

ROOM	Square Feet	Dimensions L x W	Ceiling Height	Theater	Classroom	Banquet Rounds	Reception	Conference	U-Shape	Hollow Square	Exhibits 8' x 10'
Monte Carlo Ballrooms	14,976	Irregular	12'	1,000	800	900	1,200	-	-	-	85
Ballroom 1	2,496	64' x 39'	12'	225	150	150	250	40	40	50	15
Ballroom 2	2,496	64' x 39'	12'	225	150	150	250	40	40	50	15
Ballroom 3	2,496	64' x 39'	12'	225	150	150	250	40	40	50	15
Ballroom 4	3,744	96' x 79'	12'	275	175	200	350	50	50	60	20
Ballroom 5	3,744	96' x 79'	12'	275	175	200	350	50	50	60	20
Ballrooms 1-2	4,992	64' x 78'	12'	450	300	300	500	-	80	-	30
Ballrooms 1-3	7,488	64' x 117'	12'	650	450	450	750	-	-	-	45
Ballrooms 1-4	11,232	Irregular	12'	900	600	650	1,100	-	-	-	60
Ballrooms 2-3	4,992	64' x 78'	12'	450	300	300	500	-	80	-	30
Ballrooms 2-4	8,736	Irregular	12'	650	450	450	850	-	-	-	45
Ballrooms 2-5	12,480	Irregular	12'	900	600	650	1,200	-	-	-	70
Ballrooms 3-4	6,240	Irregular	12'	450	300	300	500	-	90	-	35
Ballrooms 3-5	9,984	Irregular	12'	675	475	500	900	-	-	-	55
Ballrooms 4-5	7,488	96' x 117'	12'	500	350	400	700	-	-	-	40
East Ballrooms	8,256	96' x 86'	10'	625	450	500	850	-	-	-	45
Foyer	1,376	86' x 16'	9'	-	-	80	200	-	-	-	10
East Ballroom 6	2,400	80' x 30'	10'	220	150	140	240	40	40	50	12
East Ballroom 7	2,560	80' x 32'	10'	230	150	160	260	40	40	50	12
East Ballroom 8	1,920	80' x 24'	10'	175	110	120	220	40	35	50	10
East Ballrooms 6-7	4,960	80' x 62'	10'	450	300	300	500	-	-	-	25
East Ballrooms 7-8	4,480	80' x 56'	10'	400	260	280	480	-	-	-	22
East Ballrooms 6-8	6,880	80' x 86'	10'	625	400	420	720	-	-	-	35
East Ballroom Pre-Function	527	31' x 17'	9'	-	-	-	60	-	-	-	5
Platinum	924	43' x 21.5'	9'	50	40	40	40	30	25	30	-
Titanium	260	20' x 13'	9'	Boardroom Permanent Seating for 10							
Copper	800	40' x 20'	9'	40	30	30	30	25	25	25	-
Silver	540	27' x 20'	9'	30	20	20	25	20	15	15	-
Gold	1,400	70' x 20'	9'	60	50	50	50	40	35	40	-
Cobalt	324	27' x 12'	9'	20	15	20	20	16	-	-	-
Bronze	756	24' x 31.5'	9'	35	30	30	40	20	25	25	-
Sterling A	560	28' x 20'	10'	56	31	40	50	24	22	26	-
Sterling B	380	19' x 20'	10'	30	16	40	25	20	15	16	-
Sterling C	550	Irregular	10'	40	30	20	50	18	19	16	-
Sterling A-B	940	47' x 20'	10'	100	56	80	120	48	42	48	-

CONFERENCE ROOM FLOOR PLANS AND CAPACITIES

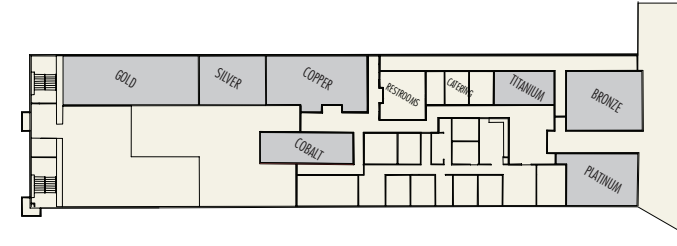

ROOM	Square Feet	Dimensions L x W	Ceiling Height	Theater	Classroom	Banquet Rounds	Reception	Conference	U-Shape	Hollow Square	Exhibits 8' x 10'
Platinum	924	43' x 21.5'	9'	50	40	40	40	30	25	30	-
Titanium	260	20' x 13'	9'	Boardroom Permanent Seating for 10							
Copper	800	40' x 20'	9'	40	30	30	30	25	25	25	-
Silver	540	27' x 20'	9'	30	20	20	25	20	15	15	-
Gold	1,400	70' x 20'	9'	60	50	50	50	40	35	40	-
Cobalt	324	27' x 12'	9'	20	15	20	20	16	-	-	-
Bronze	756	24' x 31.5'	9'	35	30	30	40	20	25	25	-

MONTE CARLO BALLROOM FLOOR PLANS AND CAPACITIES

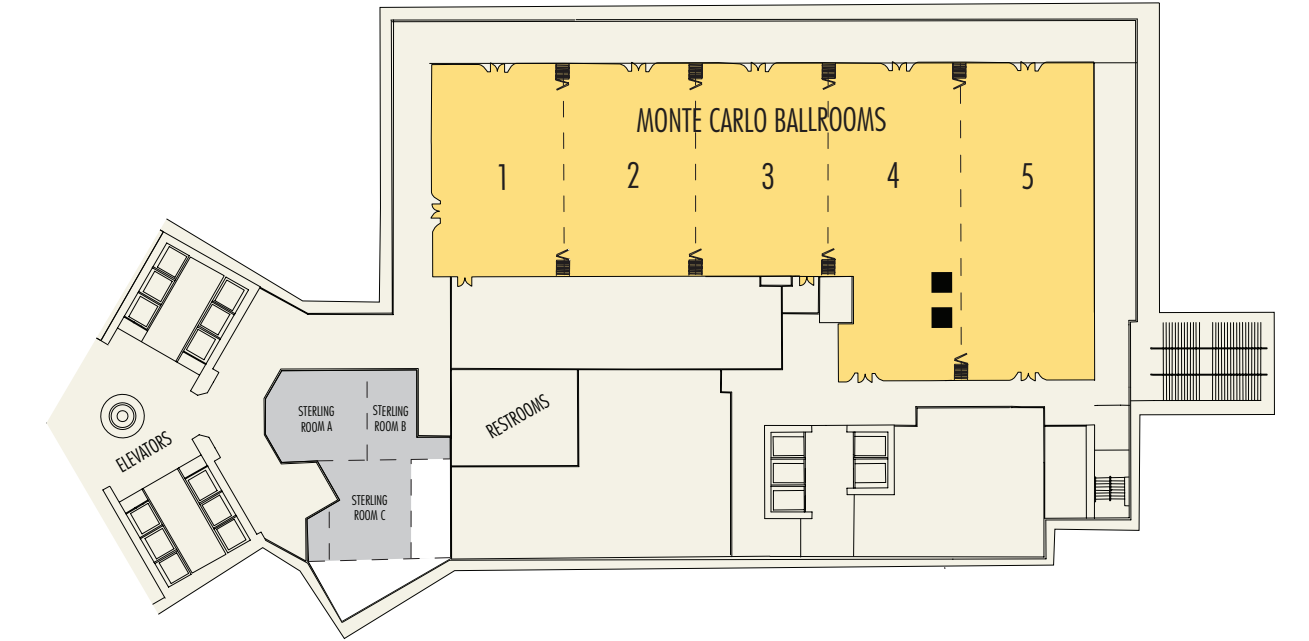

EAST BALLROOM FLOOR PLANS AND CAPACITIES

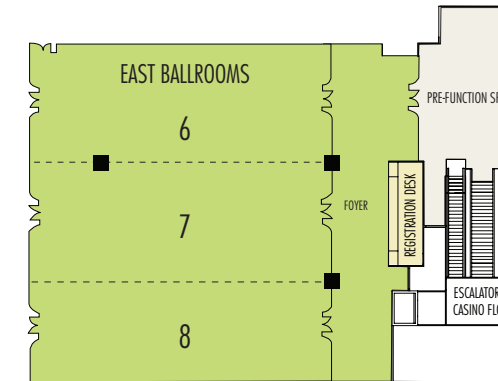

ROOMS	Square Feet	Dimensions L x W	Ceiling Height	Theater	Classroom	Banquet Rounds	Reception	Conference	U-Shape	Hollow Square	Exhibits 8' x 10'
East Ballrooms	8,256	96' x 86'	10'	625	450	500	850	-	-	-	45
Foyer	1,376	86' x 16'	9'	-	-	80	200	-	-	-	10
East Ballroom 6	2,400	80' x 30'	10'	220	150	140	240	40	40	50	12
East Ballroom 7	2,560	80' x 32'	10'	230	150	160	260	40	40	50	12
East Ballroom 8	1,920	80' x 24'	10'	175	110	120	220	40	35	50	10
East Ballrooms 6-7	4,960	80' x 62'	10'	450	300	300	500	-	-	-	25
East Ballrooms 7-8	4,480	80' x 56'	10'	400	260	280	480	-	-	-	22
East Ballrooms 6-8	6,880	80' x 86'	10'	625	400	420	720	-	-	-	35
East Ballroom Pre-Function	527	31' x 17'	9'	-	-	-	60	-	-	-	5

ROOM	Square Feet	Dimensions L x W	Ceiling Height	Theater	Classroom	Banquet Rounds	Reception	Conference	U-Shape	Hollow Square	Exhibits 8' x 10'
Monte Carlo Ballrooms	14,976	Irregular	12'	1,000	800	900	1,200	-	-	-	85
Ballroom 1	2,496	64' x 39'	12'	225	150	150	250	40	40	50	15
Ballroom 2	2,496	64' x 39'	12'	225	150	150	250	40	40	50	15
Ballroom 3	2,496	64' x 39'	12'	225	150	150	250	40	40	50	15
Ballroom 4	3,744	96' x 79'	12'	275	175	200	350	50	50	60	20
Ballroom 5	3,744	96' x 79'	12'	275	175	200	350	50	50	60	20
Ballrooms 1-2	4,992	64' x 78'	12'	450	300	300	500	-	80	-	30
Ballrooms 1-3	7,488	64' x 117'	12'	650	450	450	750	-	-	-	45
Ballrooms 1-4	11,232	Irregular	12'	900	600	650	1,100	-	-	-	60
Ballrooms 2-3	4,992	64' x 78'	12'	450	300	300	500	-	80	-	30
Ballrooms 2-4	8,736	Irregular	12'	650	450	450	850	-	-	-	45
Ballrooms 2-5	12,480	Irregular	12'	900	600	650	1,200	-	-	-	70
Ballrooms 3-4	6,240	Irregular	12'	450	300	300	500	-	90	-	35
Ballrooms 3-5	9,984	Irregular	12'	675	475	500	900	-	-	-	55
Ballrooms 4-5	7,488	96' x 117'	12'	500	350	400	700	-	-	-	40
Sterling A	560	28' x 20'	10'	56	31	40	50	24	22	26	-
Sterling B	380	19' x 20'	10'	30	16	40	25	20	15	16	-
Sterling C	550	Irregular	10'	40	30	20	50	18	19	16	-
Sterling A-B	940	47' x 20'	10'	100	56	80	120	48	42	48	-