

FLOOR PLANS AND ROOM CAPACITIES—THE CLOISTER

Location	Conference	Classroom	Banquet	Reception	Theater	Sq. Ft.
A Cloister South Parlor	—	—	—	50	—	700
B Cloister Garden	—	—	—	400	—	4,000
C Spanish Lounge	—	—	—	200	—	1,440
D Clubroom	—	—	50	100	—	1,500
E Hudson Boardroom		Permanent Boardroom Table for 14 (maximum)				576
F Sea Island Summit Room		Permanent Boardroom Table for 18 (maximum)				1,064
G Oglethorpe Room	26	60	60	76	76	984
H Cloister Ballroom I	52	90	100	105	105	1,530
I Cloister Ballroom II	—	219	300	300	300	4,161
J Cloister Ballroom III	52	90	100	105	105	1,530
K Cloister Foyer III	—	—	80	105	—	900
L St. Catherines	20	27	24	34	34	520
M Cumberland	26	21	30	44	44	665
N Cloister Patio	—	—	110	300	—	2,500
O Sapelo	26	21	30	44	44	665
P Cloister Foyer II	—	—	—	200	—	2,000
Q Ossabaw	20	27	24	34	34	520
R Cloister Foyer I	—	—	80	105	—	900
S Cloister North Parlor	—	—	—	50	—	700
T Wine Cellar	—	—	14	—	—	500
U Georgian Private Dining	—	—	12	—	—	200

THE LODGE [FIRST FLOOR]

THE LODGE [GROUND FLOOR]

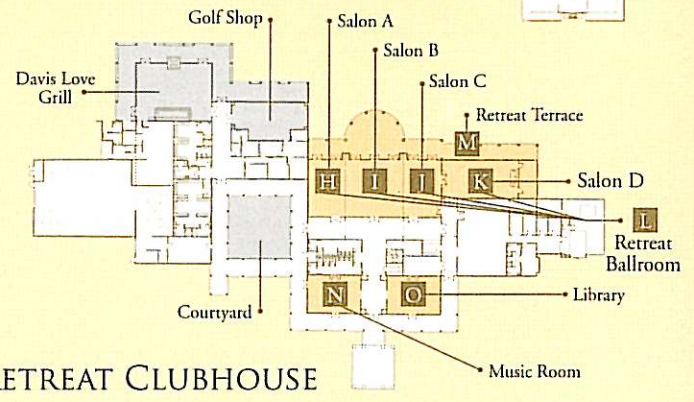
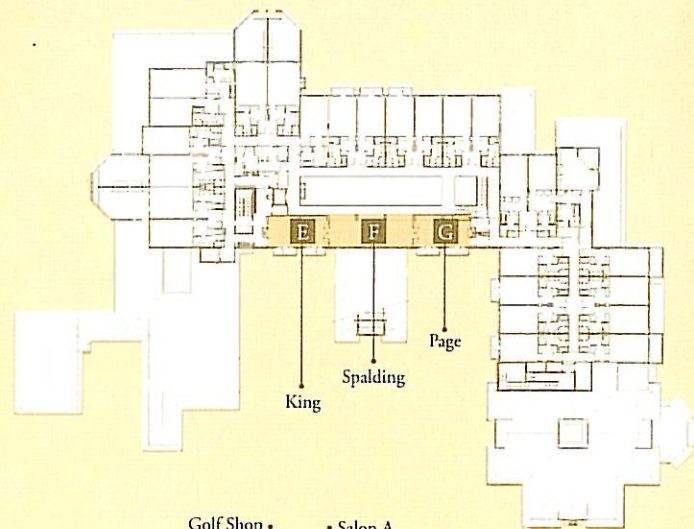
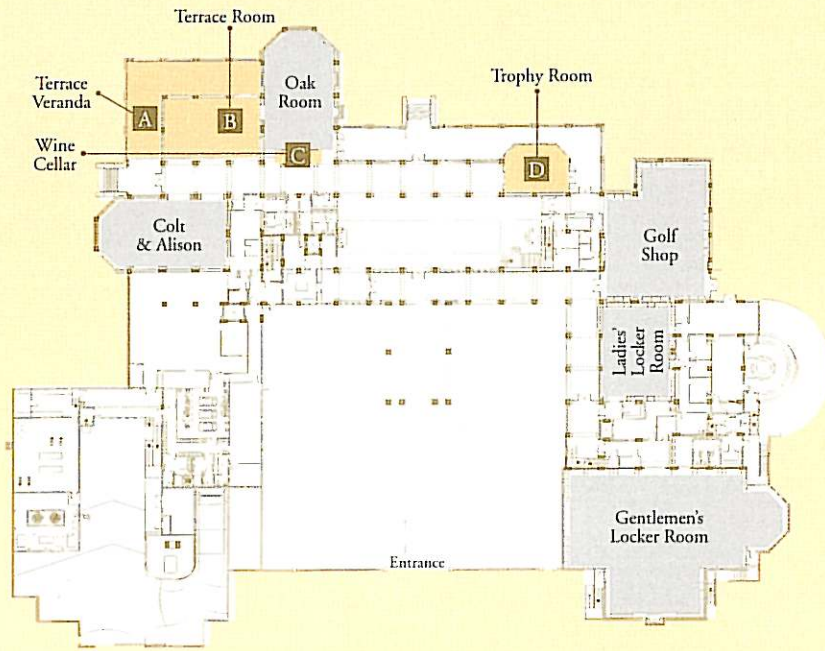

RETREAT CLUBHOUSE

FLOOR PLANS AND ROOM CAPACITIES—THE LODGE AND RETREAT CLUBHOUSE

Location	Conference	Classroom	Banquet	Reception	Theater	Sq. Ft.
A Terrace Veranda	—	—	—	70	—	900
B Terrace Room	—	—	70	—	—	1,300
C Wine Cellar	—	—	20	—	—	500
D Trophy Room + Veranda	—	—	—	70	—	1,000
E King Room	24	—	—	30	35	630
F Spalding Room	—	—	—	30	—	730
G Page Room	14	—	14	—	—	595
H Salon A	36	50	30	50	45	860
I Salon B	48	70	60	100	110	1,300
J Salon C	36	50	30	50	45	860
K Salon D	32	50	60	75	80	1,150
L Retreat Ballroom (Salons A–D)	—	200	240	310	360	4,170
M Retreat Terrace	—	—	70	100	—	900
N Music Room	—	—	—	50	—	800
O Library	—	—	—	50	—	800

CONTACT INFORMATION

Post Office Box 30351 Sea Island, Georgia 31561 800-732-4752 800-SEA ISLAND www.seaisland.com