

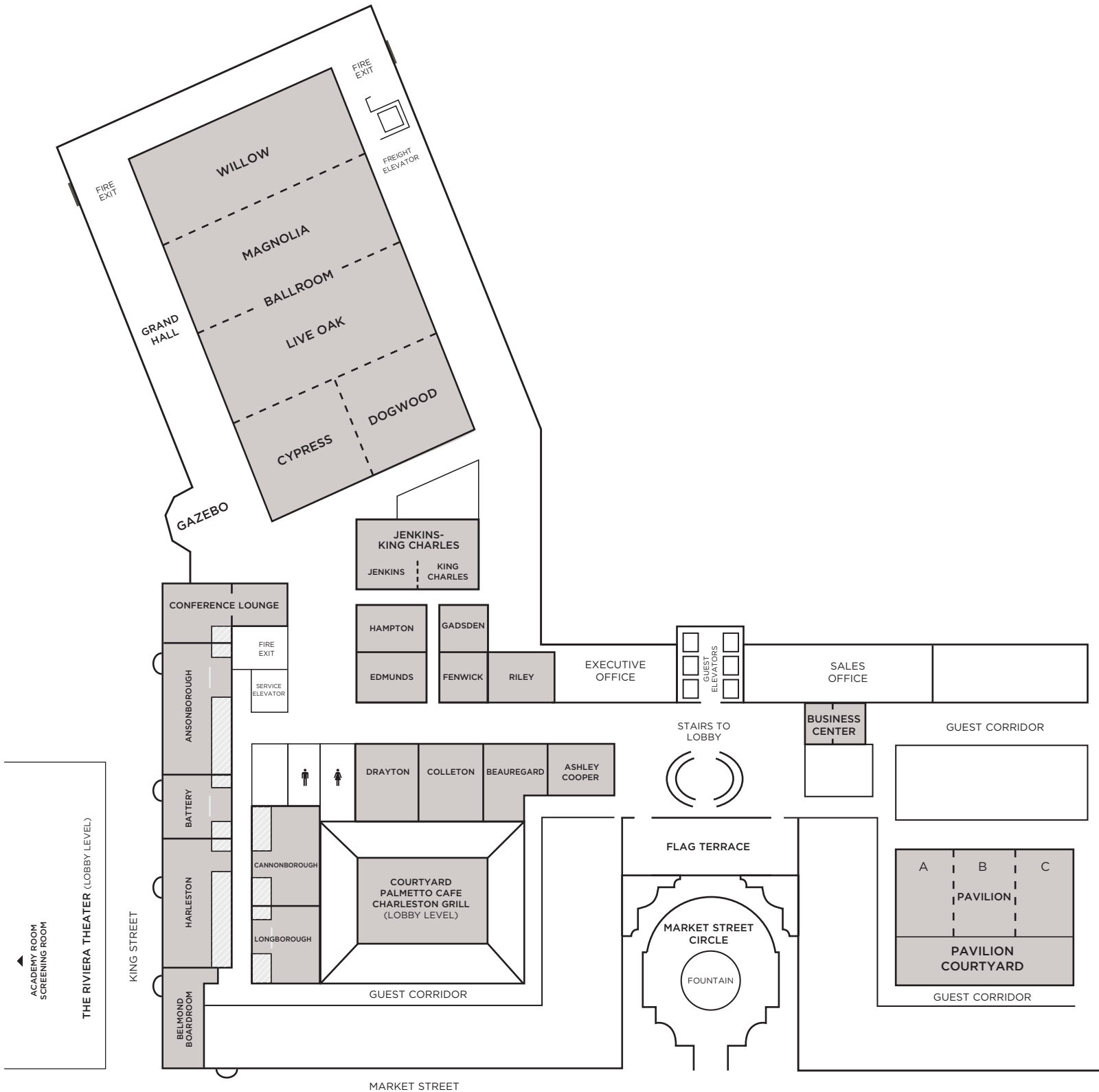

BELMOND
CHARLESTON PLACE
 CHARLESTON

FUNCTION SPACE DIAGRAM



BANQUET & MEETING ROOM CAPACITIES

We offer the ultimate in flexible meeting space, with more than 40,000 square feet within the hotel, including the Grand Ballroom (14,000+ square feet), Riviera Conference Center, 16 function rooms, two hospitality suites, two executive boardrooms, the Grand Hall and several outdoor courtyards.

	SQUARE FOOTAGE	DIMENSIONS	CEILING HEIGHT	PORTABLE WALLS	THEATER	SCHOOL ROOM	BANQUET	RECEPTION	HOLLOW SQUARE	U-SHAPED	8' X 10'	EXHIBITS 10' X 10'
BALLROOM	14,432	164' x 88'	16'	Yes	1,450	860	1,120	1,700	-	70	90	-
Cypress	1,804	41' x 44'	16'	Yes	150	96	120	200	50	40	10	8
Dogwood	1,804	41' x 44'	16'	Yes	150	96	120	200	50	40	10	8
Live Oak	3,608	41' x 88'	16'	Yes	350	216	250	250	88	80	22	15
Magnolia	3,608	41' x 88'	16'	Yes	350	216	250	250	88	80	22	15
Willow	3,608	41' x 88'	16'	Yes	350	216	250	250	88	80	22	15
Grand Hall	4,100	164' x 25'	16'	No	-	-	-	350	-	15	-	20
Gazebo	500	Oval	16'	No	-	-	-	75	-	-	-	-
MEETING ROOMS												
Jenkins-King Charles	1,296	27' x 48'	10'	Yes	100	72	80	100	40	34	-	-
Jenkins	648	27' x 24'	10'	No	40	32	40	40	22	14	-	-
King Charles	648	27' x 24'	10'	No	40	32	40	40	22	14	-	-
Colleton	780	26' x 30'	10'	No	70	36	50	65	30	24	-	-
Drayton	750	25' x 30'	10'	No	70	36	50	65	30	24	-	-
Beauregard	720	25' x 30'	10'	No	30	30	40	40	20	18	-	-
Ashley Cooper	560	20' x 28'	10'	No	30	27	30	30	20	18	-	-
Hampton	560	20' x 28'	10'	No	36	24	30	30	20	18	-	-
Edmunds	532	19' x 28'	10'	No	24	24	30	30	18	15	-	-
Gadsden	399	19' x 21'	10'	No	21	15	30	20	15	12	-	-
Fenwick	380	19' x 20'	10'	No	36	12	20	20	15	12	-	-
Riley Boardroom	532	19' x 28'	10'	No	-	-	-	-	12	(fixed boardroom)		-
Belmond Boardroom	574	41' x 14'	10'	No	-	-	-	-	22	(fixed boardroom)		-
Longborough	570	30' x 19'	10'	No	-	-	-	30	-	-	-	-
Harleston	1026	54' x 19'	10'	No	75	54	-	75-100	33	30	-	-
Cannonborough	760	51' x 19'	10'	No	60	30	-	75	28	25	-	-
Battery	570	30' x 19'	10'	No	-	-	-	30	-	-	-	-
Ansonborough	1026	54' x 19'	10'	No	75	54	-	75-100	33	30	-	-
Pavilion	1,710	57' x 30'	10'	Yes	135	90	85	125	46	-	-	-
Pavilion AB or BC	1,140	38' x 30'	10'	Yes	90	54	80	-	26	22	-	-
Pavilion A, B or C	570	19' x 30'	10'	No	45	27	40	-	18	15	-	-
Pavilion Courtyard	-	-	-	-	-	-	40	60	-	-	-	-
Flag Terrace	1,470	70' x 21'	-	-	-	-	50	75	-	-	-	-
Conference Lounge	850	-	-	-	-	-	-	-	-	-	-	-
Market Street Circle	-	-	-	-	-	-	180	250	-	-	-	-
RIVIERA												
Conference Theater	-	-	Varies	Yes	289	-	-	-	-	-	-	-
Rooftop Terrace	1,166	53' x 22'	-	No	-	-	48	75	-	-	-	-
Sottile Ballroom	4,032	84' x 48'	20'	Yes	450	250	336	550	90	75	24	18
Academy Room	1,300	40' x 33'	12'	No	100	72	80	100	40	34	-	-
Screening Room	651	21' x 31'	12'	No	50	30	48	50	30	24	-	-
RESTAURANTS												
Charleston Grill (Daytime Only)	-	-	-	-	-	-	120	-	-	-	-	-
Palmetto Cafe (Evening Only)	-	-	-	-	-	-	125	175	-	-	-	-